

MEDWAY®
Power Transmission

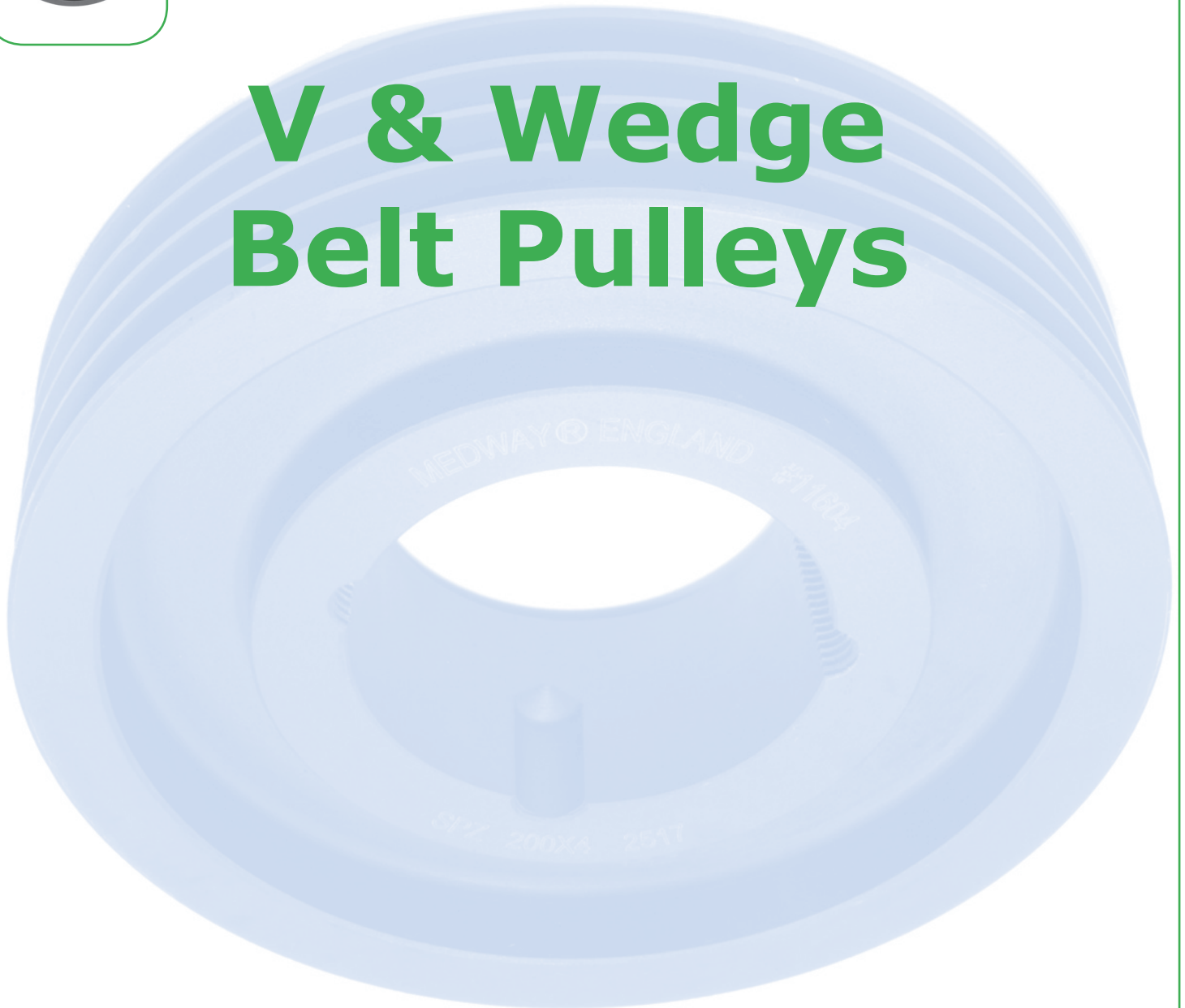

V & Wedge Belt Pulleys



MEDWAY (UK) LIMITED

M.P.T. HOUSE BRUNSWICK ROAD COBBS WOOD INDUSTRIAL ESTATE ASHFORD KENT TN23 1EL U.K.
☎ +44 (0) 1233 663340 📠 +44 (0) 1233 664440 ✉ sales@medway-uk.com 🌐 medway-uk.com

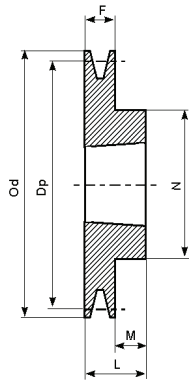

Form 1

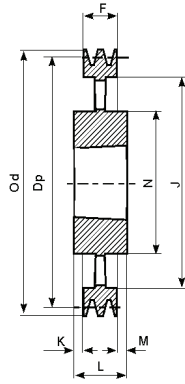

Form 4

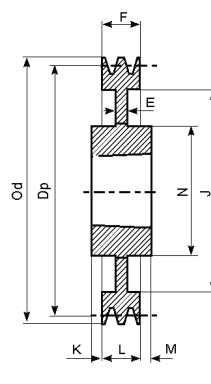

Form 7

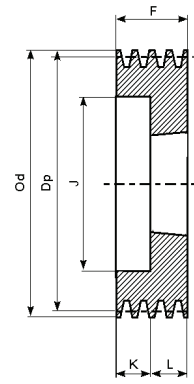

Form 9

SPZ - 1

Description	Dp.	Od.	Form	Bush No.	Max Bore	E	F	J	K	L	M	N
SPZ 50 - 1	50	54	9	1008	25		37	28	15.0	22		
SPZ 56 - 1	56	60	9	1008	25		37	23	15.0	22		
SPZ 60 - 1	60	64	9	1008	25		22			22		
SPZ 63 - 1	63	67	1	1108	28		16			22	6.0	62
SPZ 67 - 1	67	71	1	1108	28		16			22	6.0	62
SPZ 71 - 1	71	75	1	1108	28		16			22	6.0	62
SPZ 75 - 1	75	79	1	1108	28		16			22	6.0	62
SPZ 80 - 1	80	84	1	1210	32		16			25	9.0	75
SPZ 85 - 1	85	89	1	1210	32		16			25	9.0	75
SPZ 90 - 1	90	94	1	1210	32		16			25		75
SPZ 95 - 1	95	99	1	1210	32		16			25	9.0	75
SPZ 100 - 1	100	10	1	1210	32		16			25	9.0	75
SPZ 106 - 1	106	11	1	1610	42		16			25	9.0	80
SPZ 112 - 1	112	11	1	1610	42		16			25	9.0	80
SPZ 118 - 1	118	12	1	1610	42		16			25	9.0	80
SPZ 125 - 1	125	12	1	1610	42		16			25	9.0	80
SPZ 132 - 1	132	13	1	1610	42		16			25	9.0	80
SPZ 140 - 1	140	14	1	1610	42		16			25	9.0	80
SPZ 150 - 1	150	15	1	1610	42		16			25	9.0	80
SPZ 160 - 1	160	16	1	1610	42		16			25	9.0	80
SPZ 170 - 1	170	17	1	1610	42		16			25	9.0	80
SPZ 180 - 1	180	18	1	1610	42		16			25	9.0	80
SPZ 190 - 1	190	19	7	1610	42		16	161		25	9.0	80
SPZ 200 - 1	200	20	7	2012	50		16	172		32	16.0	100
SPZ 224 - 1	224	22	7	2012	50	15	16	196		32	16.0	100
SPZ 250 - 1	250	25	4	2012	50		16	222	8.0	32	8.0	100
SPZ 280 - 1	280	28	4	2012	50		16	252	8.0	32	8.0	100
SPZ 315 - 1	315	31	4	2012	50		16	287	8.0	32	8.0	100
SPZ 355 - 1	355	35	4	2012	50		16	326	8.0	32	8.0	112
SPZ 400 - 1	400	40	4	2012	50		16	371	8.0	32	8.0	112
SPZ 450 - 1	450	45	4	2517	60		16	421	14.5	45	14.5	120

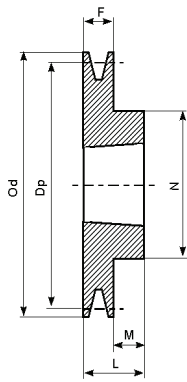

Form 1

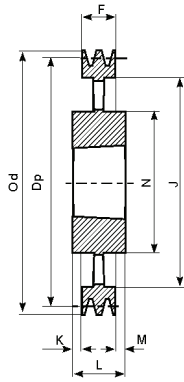

Form 4

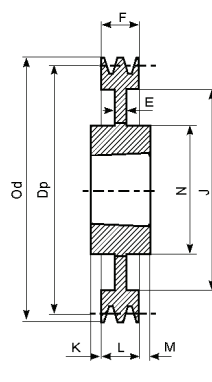

Form 7

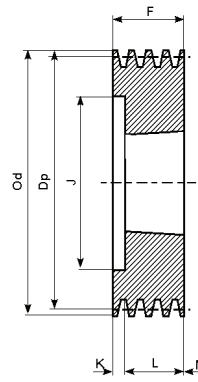

Form 8

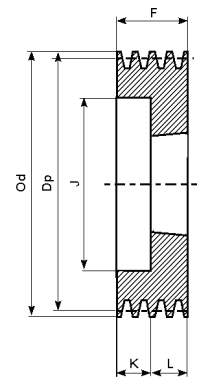

Form 9

SPZ - 2

Description	Dp.	Od.	Form	Bush No.	Max Bore	E	F	J	K	L	M	N
SPZ 50 - 2	50	54	9	1008	25		49	28	27.0	22		
SPZ 56 - 2	56	60	9	1108	28		49	35	27.0	22		
SPZ 60 - 2	60	64	9	1108	28		49	36	27.0	22		
SPZ 63 - 2	63	67	8	1108	28		28	40	6.0	22		
SPZ 67 - 2	67	71	8	1108	28		28	42	6.0	22		
SPZ 71 - 2	71	75	8	1108	28		28	42	6.0	22		
SPZ 75 - 2	75	79	8	1210	32		28	51	3.0	25		
SPZ 80 - 2	80	84	8	1210	32		28	51	3.0	25		
SPZ 85 - 2	85	89	8	1610	42		28	60	3.0	25		
SPZ 90 - 2	90	94	8	1610	42		28	61	3.0	25		
SPZ 95 - 2	95	99	8	1610	42		28	66	3.0	25		
SPZ 100 - 2	100	104	8	1610	42		28	71	3.0	25		
SPZ 106 - 2	106	110	8	1610	42		28	76	3.0	25		
SPZ 112 - 2	112	116	8	1610	42		28	84	3.0	25		
SPZ 118 - 2	118	122	8	1610	42		28	90	3.0	25		
SPZ 125 - 2	125	129	8	1610	42		28	97	3.0	25		
SPZ 132 - 2	132	136	8	1610	42		28	104	3.0	25		
SPZ 140 - 2	140	146	8	1610	42		28	115	3.0	25		
SPZ 150 - 2	150	154	1	2012	50		28			32	4.0	100
SPZ 160 - 2	160	164	1	2012	50		28			32	4.0	100
SPZ 170 - 2	170	174	1	2012	50		28			32	4.0	100
SPZ 180 - 2	180	184	7	2012	50	10	28	152		32	4.0	100
SPZ 190 - 2	190	194	7	2012	50	10	28	161		32	4.0	100
SPZ 200 - 2	200	204	7	2012	50	10	28	171		32	4.0	100
SPZ 224 - 2	224	228	7	2012	50	10	28	196		32	4.0	100
SPZ 250 - 2	250	254	4	2012	50		28	222	2.0	32	2.0	100
SPZ 280 - 2	280	284	4	2012	50		28	252	2.0	32	2.0	100
SPZ 315 - 2	315	319	4	2012	50		28	286	2.0	32	2.0	100
SPZ 355 - 2	355	359	4	2012	50		28	326	2.0	32	2.0	112
SPZ 400 - 2	400	404	4	2517	50		28	371	8.5	45	8.5	120
SPZ 450 - 2	450	454	4	2517	60		28	421	8.5	45	8.5	120

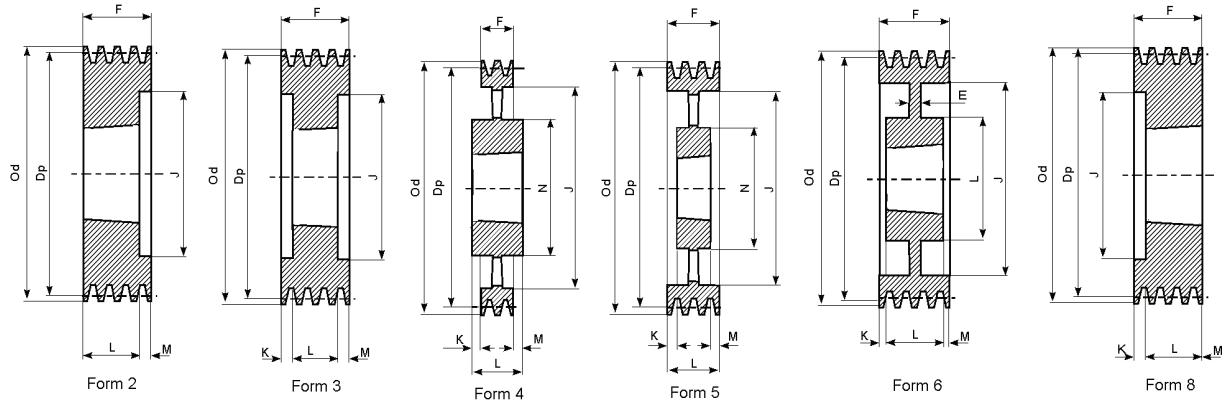

SPZ - 3

Description	Dp.	Od.	Form	Bush No.	Max Bore	E	F	J	K	L	M	N
SPZ 63x3	63	67	8	1108	28		40	40		22		
SPZ 67x3	67	71	8	1108	28		40	42	18.0	22		
SPZ 71x3	71	75	8	1108	28		40	42	18.0	22		
SPZ 75x3	75	79	8	1210	32		40	51	15.0	25		
SPZ 80x3	80	84	8	1210	32		40	51	15.0	25		
SPZ 85x3	85	89	8	1610	42		40	60	15.0	25		
SPZ 90x3	90	94	8	1610	42		40	61	15.0	25		
SPZ 95x3	95	99	8	1610	42		40	66	15.0	25		
SPZ 100x3	100	104	8	1610	42		40	71	15.0	25		
SPZ 106x3	106	110	8	1610	42		40	76	15.0	25		
SPZ 112x3	112	116	8	2012	50		40	83	8.0	32		
SPZ 118x3	118	122	8	2012	50		40	90	8.0	32		
SPZ 125x3	125	129	2	2012	50		40	96		32	8.0	
SPZ 132x3	132	136	2	2012	50		40	103		32	8.0	
SPZ 140x3	140	144	2	2012	50		40	111		32	8.0	
SPZ 150x3	150	154	2	2012	50		40	121		32	8.0	
SPZ 160x3	160	164	2	2012	50		40	131		32	8.0	
SPZ 170x3	170	174	3	2012	50		40	141	4.0	32	4.0	
SPZ 180x3	180	184	6	2012	50	7	40	151		32	8.0	106
SPZ 190x3	190	194	6	2012	50	10	40	161	4.0	32	4.0	112
SPZ 200x3	200	204	6	2012	50	10	40	171	4.0	32	4.0	112
SPZ 224x3	224	228	6	2012	50	12	40	195	4.0	32	4.0	112
SPZ 250x3	250	254	5	2012	50		40	221	4.0	32	4.0	112
SPZ 280x3	280	284	4	2517	60		40	251	2.5	45	2.5	124
SPZ 315x3	315	319	4	2517	60		40	286	2.5	45	2.5	124
SPZ 355x3	355	359	4	2517	60		40	326	2.5	45	2.5	124
SPZ 400x3	400	404	4	2517	60		40	371	2.5	45	2.5	124
SPZ 450x3	450	454	4	2517	60		40	421	2.5	45	2.5	124
SPZ 500x3	500	504	4	2517	60		40	471	2.5	45	2.5	124
SPZ 630x3	630	634	4	3020	75		40	601	5.5	51	5.5	150
SPZ 800x3	800	804	4	3020	75		40	771	5.5	51	5.5	146

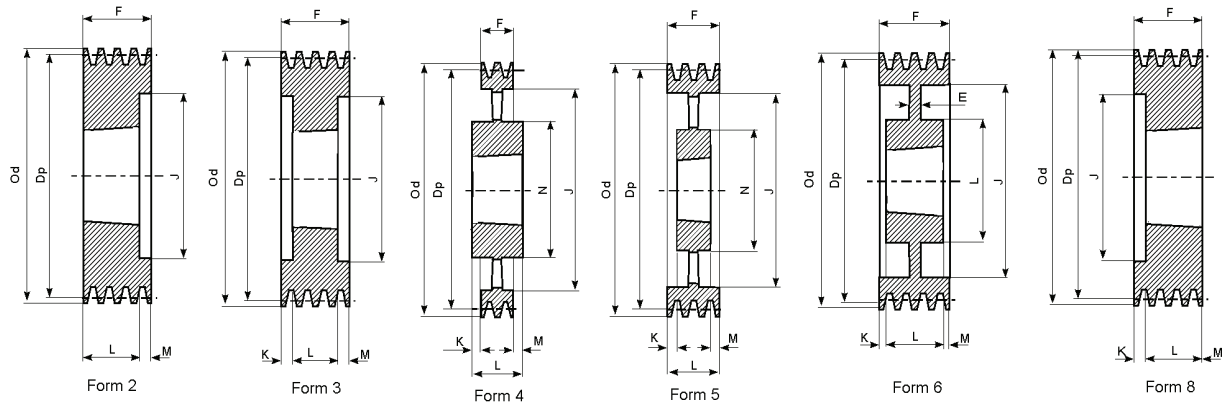

SPZ - 4

Description	Dp.	Od.	Form	Bush No.	Max Bore	E	F	J	K	L	M	N
SPZ 80x4	80	84	8	1210	32		52	51	27.0	25		
SPZ 85x4	85	89	8	1610	42		52	60	27.0	25		
SPZ 90x4	90	94	8	1610	42		52	61	27.0	25		
SPZ 95x4	95	99	8	1610	42		52	66	27.0	25		
SPZ 100x4	100	104	8	1610	42		52	71	27.0	25		
SPZ 106x4	106	110	8	1610	42		52	76	27.0	25		
SPZ 112x4	112	116	8	2012	50		52	83	20.0	32		
SPZ 118x4	118	122	8	2012	50		52	90	20.0	32		
SPZ 125x4	125	129	2	2012	50		52	96		32	20.0	
SPZ 132x4	132	136	2	2012	50		52	103		32	20.0	
SPZ 140x4	140	144	2	2012	50		52	111		32	20.0	
SPZ 150x4	150	154	2	2517	60		52	121		45	7.0	
SPZ 160x4	160	164	2	2517	60		52	131		45	7.0	
SPZ 170x4	170	174	2	2517	60		52	141		45	7.0	
SPZ 180x4	180	184	2	2517	60		52	151		45	7.0	
SPZ 190x4	190	194	3	2517	60		52	161	3.5	45	3.5	
SPZ 200x4	200	204	6	2517	60	8	52	171	3.5	45	3.5	124
SPZ 224x4	224	228	6	2517	60	14	52	195	3.5	45	3.5	124
SPZ 250x4	250	254	6	2517	60	12	52	221	3.5	45	3.5	124
SPZ 280x4	280	284	6	2517	60	14	52	251	3.5	45	3.5	124
SPZ 315x4	315	319	5	2517	60		52	286	3.5	45	3.5	124
SPZ 355x4	355	359	5	2517	60		52	326	3.5	45	3.5	124
SPZ 400x4	400	404	5	2517	60		52	371	3.5	45	3.5	124
SPZ 450x4	450	454	5	3020	75		52	421	0.5	51	0.5	146
SPZ 500x4	500	504	5	3020	75		52	471	0.5	51	0.5	146
SPZ 630x4	630	634	4	3030	75		52	601	12.0	76	12.0	146
SPZ 800x4	800	804	4	3030	75		52	771	12.0	76	12.0	146

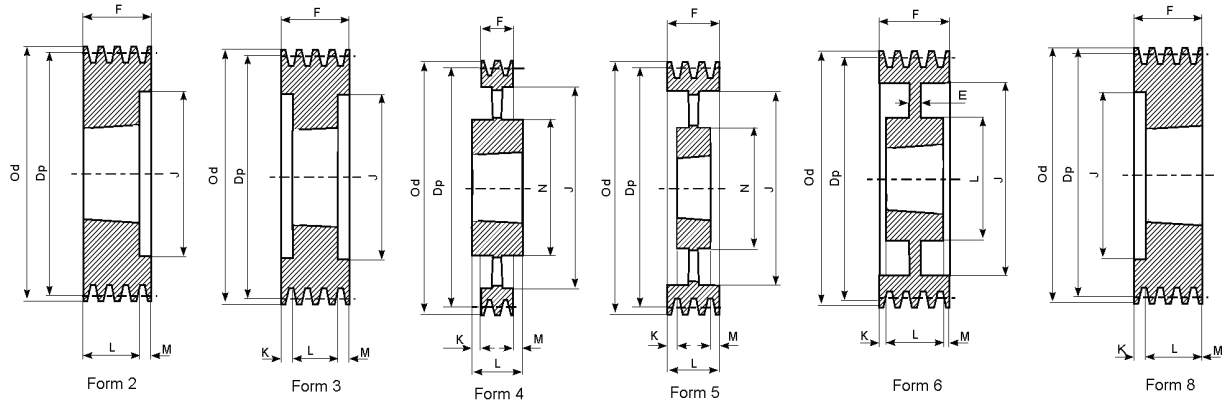

SPZ - 5

Description	Dp.	Od.	Form	Bush No.	Max Bore	E	F	J	K	L	M	N
SPZ 85x5	85	89	8	1610	42		64	60	39.0	25		
SPZ 90x5	90	94	8	1610	42		64	61	39.0	25		
SPZ 95x5	95	99	8	1610	42		64	66	39.0	25		
SPZ 100x5	100	104	8	2012	50		64	71	32.0	32		
SPZ 106x5	106	110	8	2012	50		64	76	32.0	32		
SPZ 112x5	112	116	8	2012	50		64	83	32.0	32		
SPZ 118x5	118	122	8	2012	50		64	90	32.0	32		
SPZ 125x5	125	129	8	2012	50		64	96	32.0	32		
SPZ 132x5	132	136	8	2517	60		64	103	19.0	45	19.0	
SPZ 140x5	140	144	2	2517	60		64	111		45	19.0	
SPZ 150x5	150	154	2	2517	60		64	121		45	19.0	
SPZ 160x5	160	164	2	2517	60		64	131		45	19.0	
SPZ 170x5	170	174	2	2517	60		64	141		45	19.0	
SPZ 180x5	180	184	2	2517	60		64	151		45	19.0	
SPZ 190x5	190	194	3	2517	60		64	161	9.5	45	9.5	
SPZ 200x5	200	204	3	2517	60		64	171	9.5	45	9.5	
SPZ 224x5	224	228	6	2517	60	20	64	195	9.5	45	9.5	124
SPZ 250x5	250	254	6	2517	60	16	64	221	9.5	45	9.5	124
SPZ 280x5	280	284	6	2517	60	15	64	251	9.5	45	9.5	124
SPZ 315x5	315	319	5	2517	60		64	286	9.5	45	9.5	124
SPZ 355x5	355	359	5	2517	60		64	326	9.5	45	9.5	124
SPZ 400x5	400	404	5	3020	75		64	371	6.5	51	6.5	146
SPZ 450x5	450	454	5	3020	75		64	421	6.5	51	6.5	146
SPZ 500x5	500	504	4	3030	75		64	471	6.0	76	6.0	146
SPZ 630x5	630	634	4	3030	75		64	601	6.0	76	6.0	146
SPZ 800x5	800	804	4	3535	90		64	771	12.5	89	12.5	178

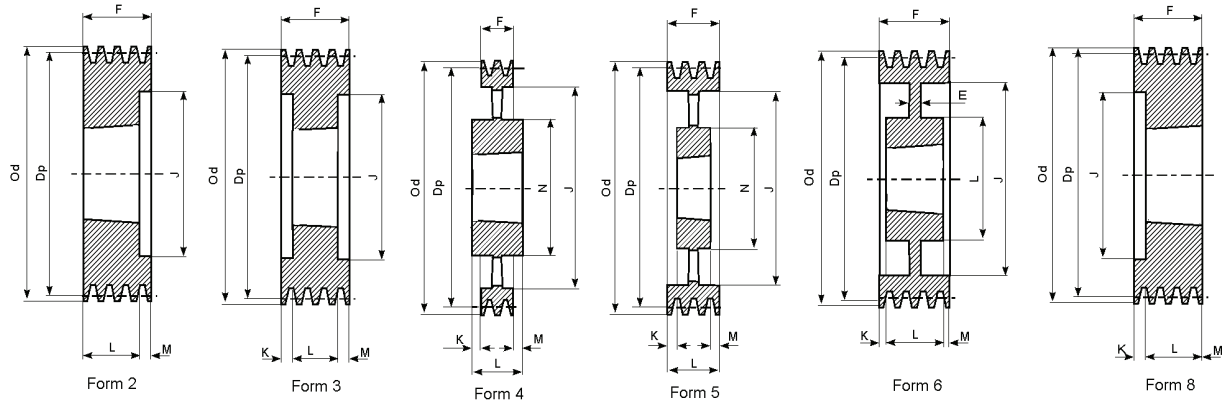

SPZ - 6

Description	Dp.	Od.	Form	Bush No.	Max Bore	E	F	J	K	L	M	N
SPZ 90x6	90	94	8	1610	42		76	61	51.0	25		
SPZ 95x6	95	99	8	1610	42		76	66	51.0	25		
SPZ 100x6	100	104	8	2012	50		76	71	44.0	32		
SPZ 106x6	106	110	8	2012	50		76	76	44.0	32		
SPZ 112x6	112	116	8	2012	50		76	83	44.0	32		
SPZ 118x6	118	122	8	2517	60		76	90	31.0	45		
SPZ 125x6	125	129	8	2517	60		76	96	31.0	45		
SPZ 132x6	132	136	8	2517	60		76	103	31.0	45		
SPZ 140x6	140	144	2	2517	60		76	111		45	31.0	
SPZ 150x6	150	154	2	2517	60		76	121		45	31.0	
SPZ 160x6	160	164	2	2517	60		76	131		45	31.0	
SPZ 170x6	170	174	2	2517	60		76	141		45	31.0	
SPZ 180x6	180	184	3	2517	60		76	151	15.5	45	15.5	
SPZ 190x6	190	194	3	2517	60		76	161	15.5	45	15.5	124
SPZ 200x6	200	204	3	2517	60		76	171	15.5	45	15.5	124
SPZ 224x6	224	228	6	2517	60	26	76	195	15.5	45	15.5	124
SPZ 250x6	250	254	6	2517	60	26	76	221	15.5	45	15.5	124
SPZ 280x6	280	284	6	2517	60	15	76	251	15.5	45	15.5	124
SPZ 315x6	315	319	6	2517	60	15	76	286	15.5	45	15.5	124
SPZ 355x6	355	359	5	2517	60		76	326	15.5	45	15.5	124
SPZ 400x6	400	404	5	3030	75		76	371		76		146
SPZ 450x6	450	454	5	3030	75		76	421		76		146
SPZ 500x6	500	504	5	3030	75		76	471		76		146
SPZ 630x6	630	634	4	3535	90		76	601	6.5	89	6.5	175
SPZ 800x6	800	804	4	3535	90		76	771	6.5	89	6.5	178

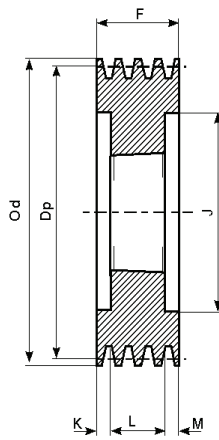

Form 3

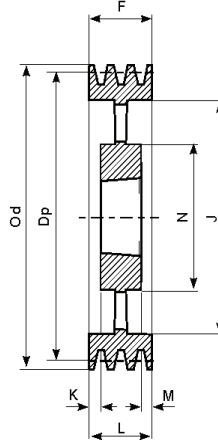

Form 5

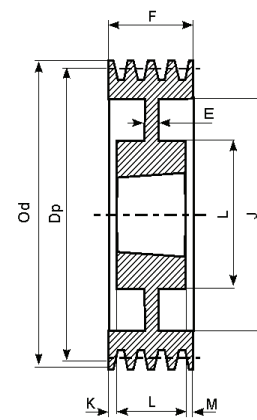

Form 6

SPZ - 8

Description	Dp.	Od.	Form	Bush No.	Max Bore	E	F	J	K	L	M	N
SPZ 140x8	140	144	3	2517	60		100	111	27.5	45	27.5	
SPZ 150x8	150	154	3	2517	60		100	121	27.5	45	27.5	
SPZ 160x8	160	164	3	2517	60		100	131	27.5	45	27.5	
SPZ 180x8	180	184	3	2517	60		100	151	27.5	45	27.5	
SPZ 200x8	200	204	3	3020	75		100	171	24.5	51	24.5	
SPZ 224x8	224	228	3	3020	75		100	195	24.6	51	24.6	
SPZ 250x8	250	254	6	3020	75	20	100	221	24.7	51	24.7	146
SPZ 280x8	280	284	6	3020	75	20	100	251	24.8	51	24.0	146
SPZ 355x8	355	359	5	3030	75		100	326	12.0	76	12.0	146
SPZ 400x8	400	404	5	3030	75		100	371	12.0	76	12.0	146
SPZ 450x8	450	454	5	3535	90		100	421	5.5	89	5.5	175

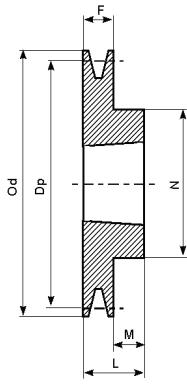

Form 1

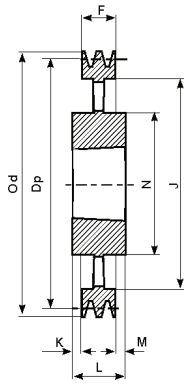

Form 4

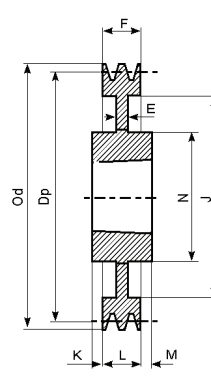

Form 7

SPA - 1

Description	Dp.	Od.	Form	Bush No.	Max Bore	E	F	J	K	L	M	N
SPA 63 - 1	63	68.5	9	1108	28		40	38	18	22		
SPA 67 - 1	67	72.5	1	1108	28		20	38		22	2	62
SPA 71 - 1	71	76.5	1	1108	28		20			22	2	62
SPA 75 - 1	75	80.5	1	1108	28		20			22	5	62
SPA 80 - 1	80	85.5	1	1210	32		20			25	5	75
SPA 85 - 1	85	90.5	1	1210	32		20			25	5	75
SPA 90 - 1	90	95.5	1	1210	32		20			25	5	75
SPA 95 - 1	95	100.5	1	1210	32		20			25	5	75
SPA 100 - 1	100	105.5	1	1610	42		20			25	5	80
SPA 106 - 1	106	111.5	1	1610	42		20			25	5	80
SPA 112 - 1	112	117.5	1	1610	42		20			25	5	80
SPA 118 - 1	118	123.5	1	1610	42		20			25	5	80
SPA 125 - 1	125	130.5	1	1610	42		20			25	5	80
SPA 132 - 1	132	137.5	1	1610	42		20			25	5	80
SPA 140 - 1	140	145.5	1	1610	42		20			25	5	80
SPA 150 - 1	150	155.5	1	1610	42		20			25	5	80
SPA 160 - 1	160	165.5	1	1610	42		20			25	5	80
SPA 170 - 1	170	175.5	1	1610	42		20			25	5	80
SPA 180 - 1	180	185.5	1	1610	42		20			25	5	80
SPA 190 - 1	190	195.5	1	1610	42		20			25	5	80
SPA 200 - 1	200	205.5	7	2012	50	10	20	165		32	12	100
SPA 224 - 1	224	229.5	7	2012	50	10	20	189		32	12	100
SPA 250 - 1	250	255.5	7	2012	50	10	20	215	6	32	6	100
SPA 280 - 1	280	285.5	7	2012	50	10	20	245		32	12	100
SPA 315 - 1	315	320.5	4	2012	50		20	280		32	12	100
SPA 355 - 1	355	360.5	4	2012	50		20	320		32	12	100
SPA 400 - 1	400	405.5	4	2012	50		20	365		32	12	100
SPA 450 - 1	450	455.5	4	2012	50		20	415		32	12	100
SPA 500 - 1	500	505.5	4	2517	60		20	465		45	25	120
SPA 630 - 1	630	635.5	4	2517	60		20	595		45	25	120

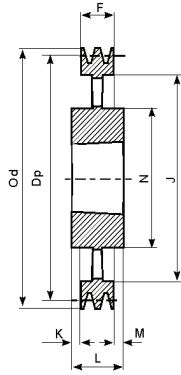

Form 4

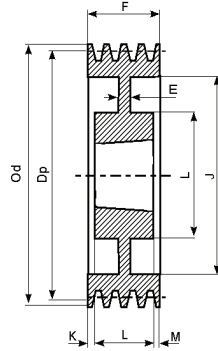

Form 6

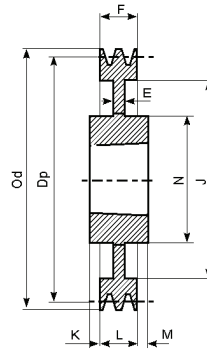

Form 7

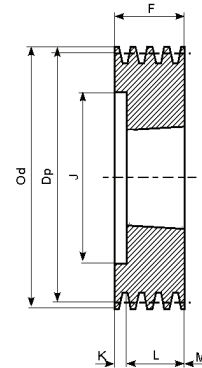

Form 8

SPA - 2

Description	Dp.	Od.	Form	Bush No.	Max Bore	E	F	J	K	L	M	N
SPA 63x2	63	68.5	8	1008	28		35	32.5	13.0	22		
SPA 67x2	67	72.5	8	1108	28		35	37.0	13.0	22		
SPA 71x2	71	76.5	8	1108	28		35	40.0	13.0	22		
SPA 75x2	75	80.5	8	1108	28		35	44.0	13.0	25		
SPA 80x2	80	85.5	8	1210	32		35	50.0	10.0	25		
SPA 85x2	85	90.5	8	1210	32		35	55.0	10.0	25		
SPA 90x2	90	95.5	8	1610	42		35	59.0	10.0	25		
SPA 95x2	95	100.5	8	1610	42		35	63.0	10.0	25		
SPA 100x2	100	105.5	8	1610	42		35	66.0	10.0	25		
SPA 106x2	106	111.5	8	1610	42		35	72.0	10.0	25		
SPA 112x2	112	117.5	8	1610	42		35	78.0	10.0	25		
SPA 118x2	118	123.5	8	1610	42		35	84.0	10.0	25		
SPA 125x2	125	130.5	8	1610	42		35	91.0	10.0	25		
SPA 132x2	132	137.5	8	2012	50		35	98.0	3.0	32		
SPA 140x2	140	145.5	8	2012	50		35	106.0	3.0	32		
SPA 150x2	150	155.5	8	2012	50		35	116.0	3.0	32		
SPA 160x2	160	165.5	8	2012	50		35	125.0	3.0	32		
SPA 170x2	170	175.5	8	2012	50		35	135.0	3.0	32		
SPA 180x2	180	185.5	6	2012	50	10	35	146.0	1.5	32	1.5	108
SPA 190x2	190	195.5	6	2012	50	6	35	156.0		32	3.0	108
SPA 200x2	200	205.5	7	2517	60	10	35	165.0	5.0	45	5.0	123
SPA 212x2	212	217.5	7	2517	60	18	35	177.0	5.0	45	5.0	123
SPA 224x2	224	229.5	7	2517	60	18	35	189.0		45	10.0	124
SPA 236x2	236	241.5	7	2517	60	12	35	202.0		45	10.0	124
SPA 250x2	250	255.5	7	2517	60	12	35	215.0	5.0	45	5.0	124
SPA 280x2	280	285.5	7	2517	60	12	35	245.0		45	10.0	124
SPA 315x2	315	320.5	7	2517	60	12	35	280.0		45	10.0	124
SPA 355x2	355	360.5	4	2517	60		35	320.0		45	10.0	124
SPA 400x2	400	405.5	4	2517	60		35	365.0		45	10.0	124
SPA 450x2	450	455.5	4	2517	60		35	465.0		45	10.0	124
SPA 500x2	500	505.5	4	2517	60		35	525.0		45	10.0	125
SPA 630x2	630	635.5	4	3020	75		35	595.0	8.0	51	18.0	159

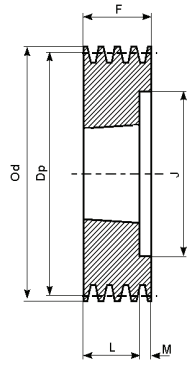

Form 2

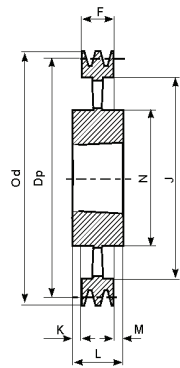

Form 4

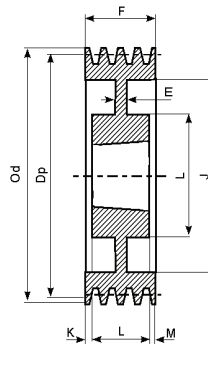

Form 6

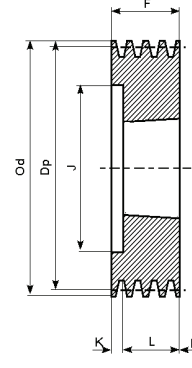

Form 8

SPA - 3

Description	Dp.	Od.	Form	Bush No.	Max Bore	E	F	J	K	L	M	N
SPA 71x3	71	76.5	8	1108	28		50	40	28.00	22		
SPA 75x3	75	80.5	8	1108	28		50	44	28.00	22		
SPA 80x3	80	85.5	8	1210	32		50	50	25.00	25		
SPA 85x2	85	90.5	8	1210	32		50	55	25.00	25		
SPA 90x3	90	95.5	8	1610	42		50	59	25.00	25		
SPA 95x3	95	100.5	8	1610	42		50	63	25.00	25		
SPA 100x3	100	105.5	2	1610	42		50	66		25	25.00	
SPA 106x3	106	111.5	2	1610	42		50	72		25	25.00	
SPA 112x3	112	117.5	8	2012	50		50	78	18.00	32		
SPA 118x3	118	123.5	2	2012	50		50	84		32	18.00	
SPA 125x3	125	130.5	2	2012	50		50	91		32	18.00	
SPA 132x3	132	137.5	2	2012	50		50	98		32	18.00	
SPA 140x3	140	145.5	8	2517	60		50	106	5.00	45		
SPA 150x3	150	155.5	8	2517	60		50	116	5.00	45		
SPA 160x3	160	165.5	8	2517	60		50	125	5.00	45		
SPA 170x3	170	175.5	8	2517	60		50	135	5.00	45		
SPA 180x3	180	185.5	8	2517	60		50	146	5.00	45		
SPA 190x3	190	195.5	8	2517	60		50	156	5.00	45		
SPA 200x3	200	205.5	6	2517	60	20	50	165	2.50	45	2.50	123
SPA 212x3	212	217.5	6	2517	60	20	50	177	2.50	45	2.50	123
SPA 224x3	224	229.5	6	2517	60	20	50	189	2.50	45	2.50	124
SPA 236x3	236	241.5	6	2517	60	20	50	202	2.50	45	2.50	124
SPA 250x3	250	255.5	6	2517	60	20	50	215	2.50	45	2.50	124
SPA 280x3	280	285.5	6	2517	60	20	50	245	2.50	45	2.50	124
SPA 315x3	315	320.5	4	3020	75	25	50	280	0.50	51	0.50	159
SPA 355x3	355	360.5	4	3020	75		50	320	0.50	51	0.50	159
SPA 400x3	400	405.5	4	3020	75		50	365		51	1.00	159
SPA 450x3	450	455.5	4	3020	75		50	415		51	1.00	159
SPA 500x3	500	505.5	4	3020	75		50	465		51	1.00	159
SPA 560x3	560	565.5	4	3020	75		50	525		51	1.00	150
SPA 630x3	630	635.5	4	3020	75		50	595		51	1.00	150
SPA 800x3	800	805.5	4	3535	90		50	765	19.05	89	19.05	175
SPA 1000x3	1000	1005.5	4	3535	90		50	965	19.05	89	19.05	175

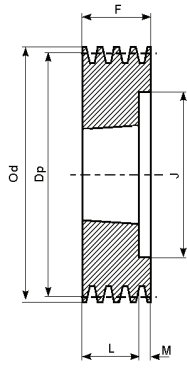

Form 2

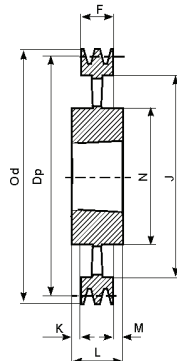

Form 4

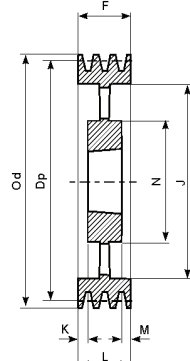

Form 5

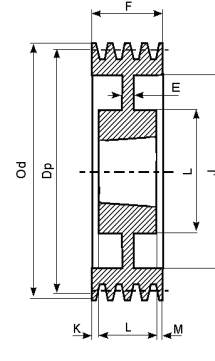

Form 6

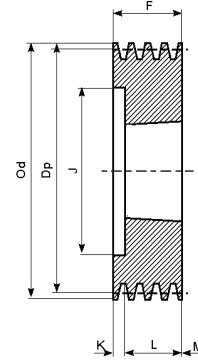

Form 8

SPA - 4

Description	Dp.	Od.	Form	Bush No.	Max Bore	E	F	J	K	L	M	N
SPA 90x4	90	95.5	8	1615	42		65	59	27.0	38		
SPA 95x4	95	100.5	8	1615	42		65	63	27.0	38		
SPA 100x4	100	105.5	2	1615	42		65	66		38	27.0	
SPA 106x4	106	111.5	8	2012	50		65	72	33.0	32		
SPA 112x4	112	117.5	8	2012	50		65	78	33.0	32		
SPA 118x4	118	123.5	2	2012	50		65	84		32	33.0	
SPA 125x4	125	130.5	2	2012	50		65	91		32	33.0	
SPA 132x4	132	137.5	2	2517	60		65	98		45	20.0	
SPA 140x4	140	145.5	2	2517	60		65	106		45	20.0	
SPA 150x4	150	155.5	2	2517	60		65	116		45	20.0	
SPA 160x4	160	165.5	2	2517	60		65	125		45	20.0	
SPA 170x4	170	175.5	2	2517	60		65	135		45	20.0	
SPA 180x4	180	185.5	2	2517	60		65	146		45	20.0	
SPA 190x4	190	195.5	2	2517	60		65	156		45	20.0	
SPA 200x4	200	205.5	2	3020	75		65	165		51	14.0	
SPA 212x4	212	217.5	2	3020	75		65	177		51	14.0	
SPA 224x4	224	229.5	2	3020	75		65	189		51	14.0	
SPA 236x4	236	241.5	6	3020	75	25	65	202		51	14.0	
SPA 250x4	250	255.5	6	3020	75	20	65	215	7.0	51	7.0	159
SPA 280x4	280	285.5	6	3020	75	25	65	245	7.0	51	7.0	159
SPA 315x4	315	320.5	6	3020	75	25	65	280	7.0	51	7.0	159
SPA 355x4	355	360.5	5	3020	75		65	320	7.0	51	7.0	159
SPA 400x4	400	405.5	5	3020	75		65	365	7.0	51	7.0	159
SPA 450x4	450	455.5	5	3020	75		65	415	7.0	51	7.0	159
SPA 500x4	500	505.5	5	3020	75		65	465	7.0	51	7.0	159
SPA 560x4	560	565.5	4	3535	90		65	525	12.0	89	12.0	175
SPA 630x4	630	635.5	4	3535	90		65	595	12.0	89	12.0	175
SPA 800x4	800	805.5	4	3535	90		65	765	12.0	89	12.0	175
SPA 1000x4	1000	1005.5	4	4040	100		65	965	18.5	102	18.5	210

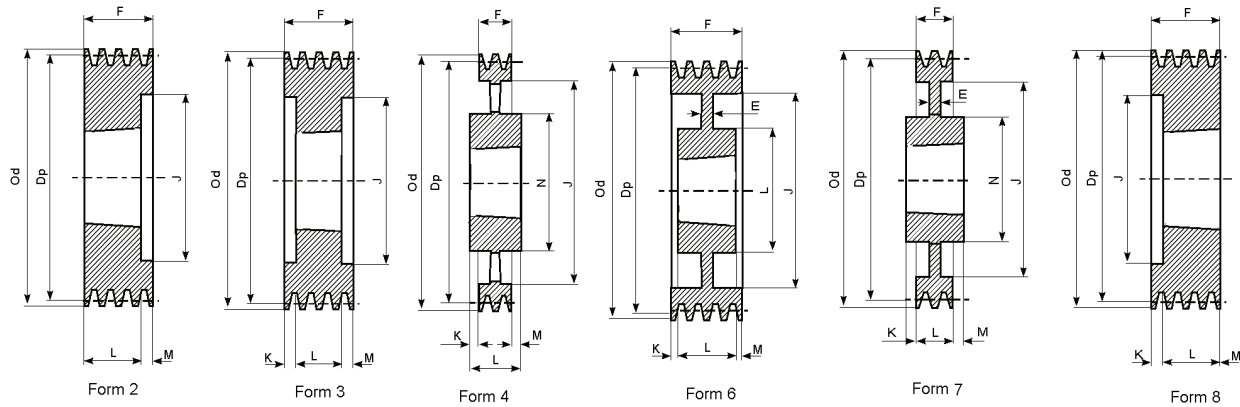

SPA - 5

Description	Dp.	Od.	Form	Bush No.	Max Bore	E	F	J	K	L	M	N
SPA 100x5	100	105.5	2	1615	42		80	66		38	42.0	
SPA 106x5	106	111.5	8	2012	50		80	72	48.0	32		
SPA 112x5	112	117.5	8	2012	50		80	78	48.0	32		
SPA 118x5	118	123.5	2	2012	50		80	84		32	48.0	
SPA 125x5	125	130.5	3	2012	50		80	91	24.0	32	24.0	
SPA 132x5	132	137.5	3	2517	60		80	98	17.5	45	17.5	
SPA 140x5	140	145.5	3	2517	60		80	106	17.5	45	17.5	
SPA 150x5	150	155.5	3	2517	60		80	116	17.5	45	17.5	
SPA 160x5	160	165.5	3	2517	60		80	125	17.5	45	17.5	
SPA 170x5	170	175.5	3	2517	60		80	135	17.5	45	17.5	
SPA 180x5	180	185.5	2	3020	75		80	146		51	29.0	
SPA 190x5	190	195.5	3	3020	75		80	156	14.5	51	14.5	
SPA 200x5	200	205.5	2	3020	75		80	165	14.5	51	14.5	
SPA 212x5	212	217.5	2	3020	75		80	177		51	29.0	
SPA 224x5	224	229.5	2	3020	75		80	189		51	29.0	
SPA 236x5	236	241.5	6	3020	75		80	202		51	29.0	
SPA 250x5	250	255.5	7	3020	75	20	80	215	14.5	51	14.5	159
SPA 280x5	280	285.5	7	3535	90	25	80	245	4.5	89	4.5	175
SPA 315x5	315	320.5	4	3535	90	25	80	280	4.5	89	4.5	175
SPA 355x5	355	360.5	4	3535	90		80	320	4.5	89	4.5	175
SPA 400x5	400	405.5	4	3535	90		80	365	4.5	89	4.5	175
SPA 450x5	450	455.5	4	3535	90		80	415	4.5	89	4.5	175
SPA 500x5	500	505.5	4	3535	90		80	465	4.5	89	4.5	175
SPA 560x5	560	565.5	4	3535	90		80	525	4.5	89	4.5	175
SPA 630x5	630	635.5	4	3535	90		80	595	4.5	89	4.5	175
SPA 800x5	800	805.5	4	4040	100		80	765	11.0	102	11.0	210
SPA 1000x5	1000	1005.5	4	4545	110		80	965	17.0	114	17.0	242

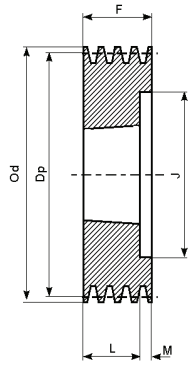

Form 2

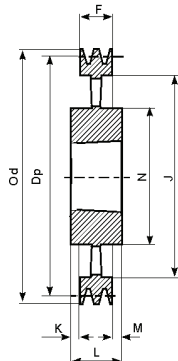

Form 4

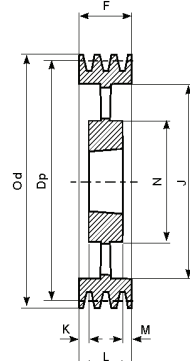

Form 5

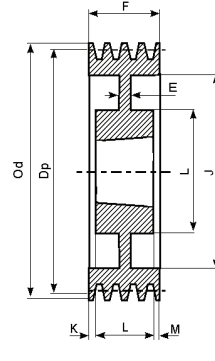

Form 6

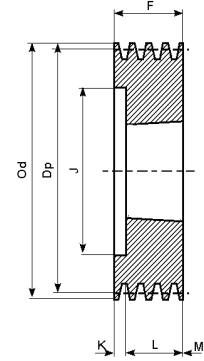

Form 8

SPA - 6

Description	Dp.	Od.	Form	Bush No.	Max Bore	E	F	J	K	L	M	N
SPA 100x6	100	105.5	3	1610	42		95	66	30.0	25	40.0	
SPA 106x6	106	111.5	8	2012	50		95	72	63.0	32		
SPA 112x6	112	117.5	8	2012	50		95	78	63.0	32		
SPA 118x6	118	123.5	8	2012	50		95	84	63.0	32		
SPA 125x6	125	130.5	3	2012	50		95	91	31.5	32	31.5	
SPA 132x6	132	137.5	3	2517	60		95	98	25.0	45	25.0	
SPA 140x6	140	145.5	3	2517	60		95	106	25.0	45	25.0	
SPA 150x6	150	155.5	3	2517	60		95	116	25.0	45	25.0	
SPA 160x6	160	165.5	3	2517	60		95	125	25.0	45	25.0	
SPA 180x6	180	185.5	3	3020	75		95	146	22.0	51	22.0	
SPA 200x6	200	205.5	3	3020	75		95	165	22.0	51	22.0	
SPA 224x6	224	229.5	3	3020	75		95	189	22.0	51	22.0	
SPA 236x6	236	241.5	3	3020	75		95	202	22.0	51	22.0	
SPA 250x6	250	255.5	6	3020	75	20	95	215	22.0	51	22.0	155
SPA 280x6	280	285.5	6	3535	90	25	95	245	3.0	89	3.0	175
SPA 315x6	315	320.5	6	3535	90	25	95	280	3.0	89	3.0	175
SPA 355x6	355	360.5	5	3535	90		95	320	3.0	89	3.0	175
SPA 400x6	400	405.5	5	3535	90		95	365	3.0	89	3.0	175
SPA 450x6	450	455.5	5	3535	90		95	415	3.0	89	3.0	175
SPA 500x6	500	505.5	5	3535	90		95	465	3.0	89	3.0	175
SPA 560x6	560	565.5	5	3535	90		95	525	3.0	89	3.0	175
SPA 630x6	630	635.5	4	4040	100		95	595	3.5	102	3.5	210
SPA 800x6	800	805.5	4	4040	100		95	765	3.5	102	3.5	210
SPA 1000x6	1000	1005.5	4	4040	110		95	965	9.5	114	9.5	242

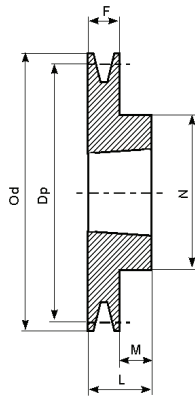

Form 1

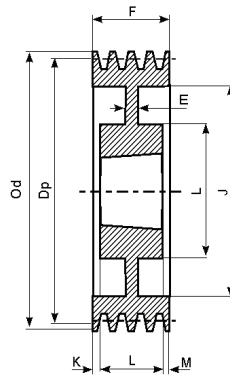

Form 6

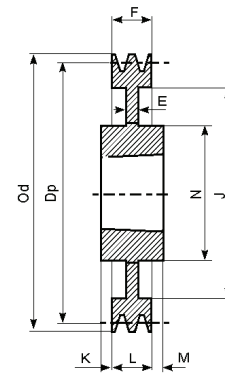

Form 7

SPB - 1

Description	Dp.	Od.	Form	Bush No.	Max Bore	E	F	J	K	L	M	N
SPB 100x1	100	107	1	1610	42		25			25		
SPB 106x1	106	113	1	1610	42		25			25		
SPB 112x1	112	119	1	1610	42		25			25		
SPB 118x1	118	125	1	1610	42		25			25		
SPB 125x1	125	132	1	1610	42		25			25		
SPB 132x1	132	139	1	1610	42		25			25		
SPB 140x1	140	147	1	1610	42		25			25		
SPB 150x1	150	157	1	1610	42		25			25		
SPB 160x1	160	167	1	1610	42		25			25		
SPB 170x1	170	177	1	1610	42		25			25		
SPB 180x1	180	187	6	1610	42	15	25	132		25		90
SPB 190x1	190	197	7	2012	50	15	25	147	3.5	32	3.5	104
SPB 200x1	200	207	7	2012	50	15	25	157	3.5	32	3.5	104
SPB 212x1	212	219	7	2012	50	15	25	169	3.5	32	3.5	104
SPB 224x1	224	231	7	2012	50	15	25	181	3.5	32	3.5	104
SPB 236x1	236	243	7	2012	50	15	25	193	3.5	32	3.5	104
SPB 250x1	250	257	7	2012	50	20	25	207	3.5	32	3.5	104
SPB 280x1	280	287	7	2012	50	20	25	237	3.5	32	3.5	104
SPB 300x1	300	307	7	2012	50	20	25	257	3.5	32	3.5	104
SPB 315x1	315	322	7	2012	50	20	25	272	3.5	32	3.5	104

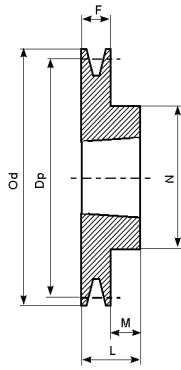

Form 1

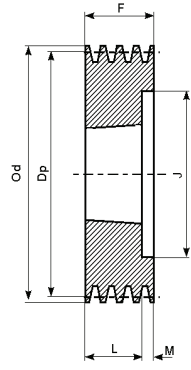

Form 2

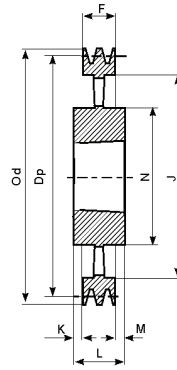

Form 4

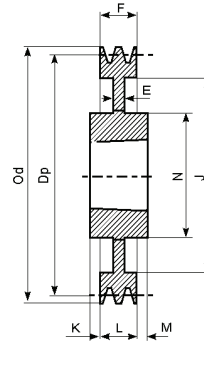

Form 7

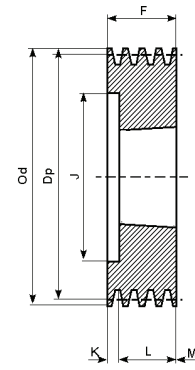

Form 8

SPB - 2

Description	Dp.	Od.	Form	Bush No.	Max Bore	E	F	J	K	L	M	N
SPB 100x2	100	107	8	1610	42		44	62	19.0	25		
SPB 106x2	106	113	8	1610	42		44	67	19.0	25		
SPB 112x2	112	119	8	1610	42		44	72	19.0	25		
SPB 118x2	118	125	2	1610	42		44	78		25	19.0	
SPB 125x2	125	132	2	2012	50		44	82		32	12.0	
SPB 132x2	132	139	2	2012	50		44	89		32	12.0	
SPB 140x2	140	147	2	2012	50		44	97		32	12.0	
SPB 150x2	150	157	2	2012	50		44	107		32	12.0	
SPB 160x2	160	167	2	2012	50		44	117		32	12.0	
SPB 170x2	170	177	2	2012	50		44	127		32	12.0	
SPB 180x2	180	187	1	2517	60		44			45	1.0	120
SPB 190x2	190	197	1	2517	60		44			45	1.0	120
SPB 200x2	200	207	1	2517	60		44			45	1.0	117
SPB 212x2	212	219	7	2517	60	20	44	169		45	1.0	117
SPB 224x2	224	231	7	2517	60	15	44	181		45	1.0	117
SPB 236x2	236	243	7	2517	60	15	44	193		45	1.0	117
SPB 250x2	250	257	7	2517	60	20	44	207		45	1.0	125
SPB 280x2	280	287	7	2517	60	20	44	237		45	1.0	125
SPB 300x2	300	307	7	2517	60	20	44	257		45	1.0	125
SPB 315x2	315	322	7	2517	60	20	44	272		45	1.0	125
SPB 335x2	335	342	7	2517	60	20	44	292		45	1.0	125
SPB 355x2	355	362	7	3020	75	15	44	312	3.5	51	3.5	144
SPB 400x2	400	407	4	3020	75		44	357	3.5	51	3.5	150
SPB 450x2	450	457	4	3020	75		44	407	3.5	51	3.5	150
SPB 500x2	500	507	4	3020	75		44	457	3.5	51	3.5	150
SPB 560x2	560	567	4	3030	75		44	517	4.0	76	28.0	150
SPB 630x2	630	637	4	3030	75		44	587	16.0	76	16.0	150

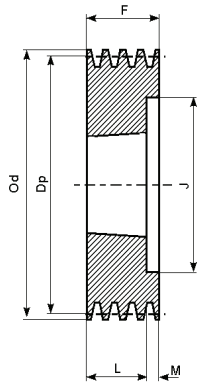

Form 2

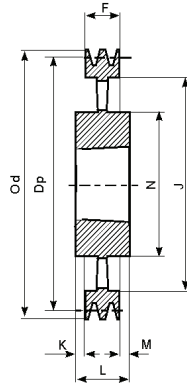

Form 4

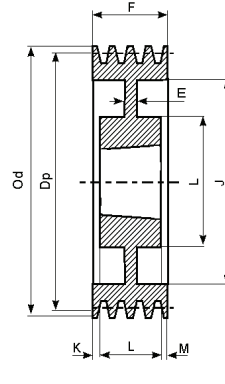

Form 6

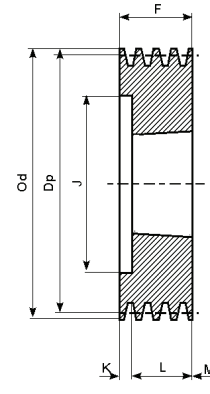

Form 8

SPB - 3

Description	Dp.	Od.	Form	Bush No.	Max Bore	E	F	J	K	L	M	N
SPB 100x3	100	107	8	1610	42		63	62	38.0	25		
SPB 106x3	106	113	8	1610	42		63	67	38.0	25		
SPB 112x3	112	119	8	1610	42		63	72	38.0	25		
SPB 118x3	118	125	2	1610	42		63	78		25	38.0	
SPB 125x3	125	132	2	2012	50		63	82		32	31.0	
SPB 132x3	132	139	2	2012	50		63	89		32	31.0	
SPB 140x3	140	147	2	2012	50		63	97		32	31.0	
SPB 150x3	150	157	2	2517	60		63	107		45	18.0	
SPB 160x3	160	167	2	2517	60		63	117		45	18.0	
SPB 170x3	170	177	2	2517	60		63	127		45	18.0	
SPB 180x3	180	187	2	2517	60		63	137		45	18.0	
SPB 190x3	190	197	2	2517	60		63	147		45	18.0	
SPB 200x3	200	207	2	2517	60		63	157		45	18.0	
SPB 212x3	212	219	6	2517	60	15	63	169		45	18.0	117
SPB 224x3	224	231	6	2517	60	15	63	181		45	18.0	117
SPB 236x3	236	243	6	2517	60	15	63	193		45	18.0	117
SPB 250x3	250	257	6	3020	75	20	63	207		51	12.0	144
SPB 280x3	280	287	6	3020	75	20	63	237	6.0	51	6.0	144
SPB 300x3	300	307	6	3020	75	20	63	257	6.0	51	6.0	144
SPB 315x3	315	322	6	3020	75	20	63	272	6.0	51	6.0	144
SPB 335x3	335	342	6	3020	75	20	63	292	6.0	51	6.0	144
SPB 355x3	355	362	6	3020	75	15	63	312	6.0	51	6.0	144
SPB 400x3	400	407	4	3535	90		63	357	13.0	89	13.0	175
SPB 450x3	450	457	4	3535	90		63	407		89	26.0	175
SPB 500x3	500	507	4	3535	90		63	457		89	26.0	175
SPB 560x3	560	567	4	3535	90		63	517		89	26.0	175
SPB 630x3	630	637	4	3535	90		63	587		89	26.0	175
SPB 710x3	710	717	4	3535	90		63	664	13.0	89	13.0	175
SPB 800x3	800	807	4	3535	90		63	754	13.0	89	13.0	175
SPB 900x3	900	907	4	3535	90		63	854	13.0	89	13.0	175
SPB 1000x3	1000	1007	4	4040	100		63	954	19.5	102	19.5	210
SPB 1250x3	1250	1257	4	4040	100		63	1204	19.5	102	19.5	210

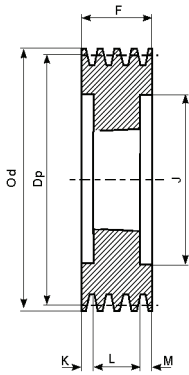

Form 3

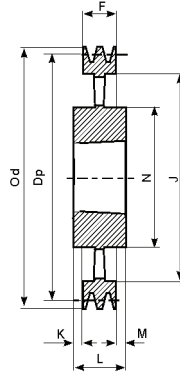

Form 4

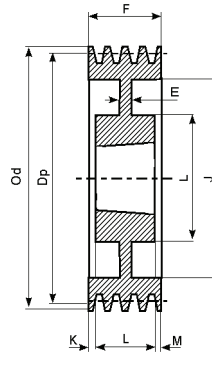

Form 6

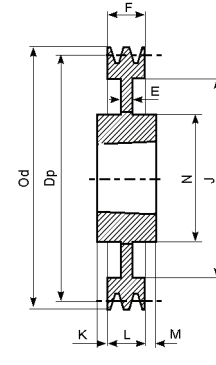

Form 7

SPB - 4

Description	Dp.	Od.	Form	Bush No.	Max Bore	E	F	J	K	L	M	N
SPB 125x4	125	132	3	2012	50		82	82	25.0	32	25.0	
SPB 132x4	132	139	3	2012	50		82	89	25.0	32	25.0	
SPB 140x4	140	147	3	2517	60		82	100	18.5	45	18.5	
SPB 150x4	150	157	3	2517	60		82	107	18.5	45	18.5	
SPB 160x4	160	167	3	2517	60		82	117	18.5	45	18.5	
SPB 170x4	170	177	3	2517	60		82	127	18.5	45	18.5	
SPB 180x4	180	187	3	2517	60		82	137	18.5	45	18.5	
SPB 190x4	190	197	3	2517	60		82	147	18.5	45	18.5	
SPB 200x4	200	207	3	3020	75		82	157	15.5	51	15.5	
SPB 212x4	212	219	3	3020	75		82	169	15.5	51	15.5	
SPB 224x4	224	231	3	3020	75		82	181	15.5	51	15.5	
SPB 236x4	236	243	3	3020	75		82	193	15.5	51	15.5	
SPB 250x4	250	257	6	3020	75	25	82	207	15.5	51	15.5	144
SPB 280x4	280	287	6	3020	75	25	82	237	15.5	51	15.5	144
SPB 300x4	300	307	7	3535	90	25	82	257		89	7.0	175
SPB 315x4	315	322	7	3535	90	25	82	272	3.5	89	3.5	175
SPB 335x4	335	342	7	3535	90	25	82	292	3.5	89	3.5	175
SPB 355x4	355	362	7	3535	90	25	82	312	3.5	89	3.5	175
SPB 400x4	400	407	4	3535	90		82	357	3.5	89	3.5	175
SPB 450x4	450	457	4	3535	90		82	407		89	7.0	175
SPB 500x4	500	507	4	3535	90		82	457		89	7.0	175
SPB 560x4	560	567	4	3535	90		82	517		89	7.0	175
SPB 630x4	630	637	4	3535	90		82	587		89	7.0	175
SPB 710x4	710	717	4	3535	90		82	664	3.5	89	3.5	175
SPB 800x4	800	807	4	4040	100		82	754	10.0	102	10.0	210
SPB 900x4	900	907	4	4040	100		82	854	10.0	102	10.0	210
SPB 1000x4	1000	1007	4	4040	100		82	954	10.0	102	10.0	210
SPB 1250x4	1250	1257	4	4545	100		82	1204	16.0	114	16.0	210

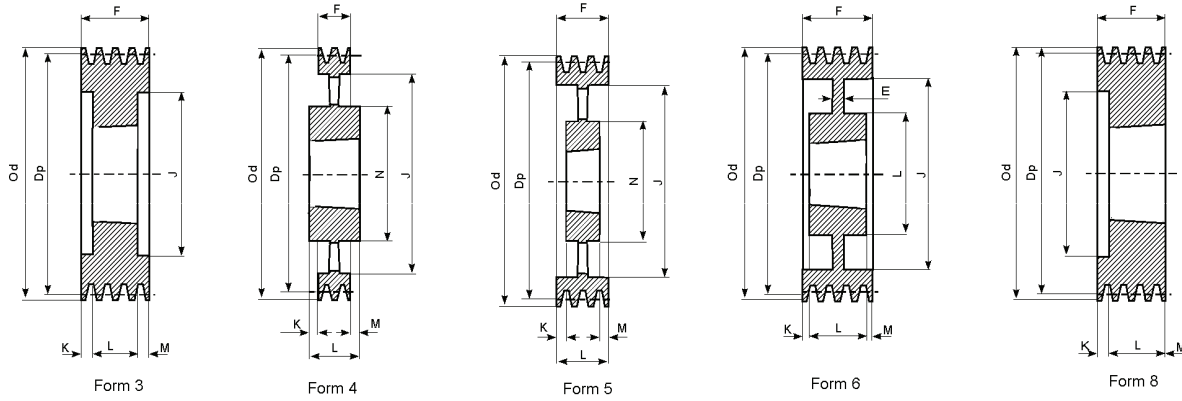

SPB - 5

Description	Dp.	Od.	Form	Bush No.	Max Bore	E	F	J	K	L	M	N
SPB 125x5	125	132	8	2012	50		101	87	69.0	32		
SPB 132x5	132	139	8	2517	60		101	94	56.0	45		
SPB 140x5	140	147	3	2517	60		101	97	28.0	45	28.0	
SPB 150x5	150	157	3	2517	60		101	107	28.0	45	28.0	
SPB 160x5	160	167	3	2517	60		101	117	28.0	45	28.0	
SPB 170x5	170	177	3	3020	75		101	127	25.0	51	25.0	
SPB 180x5	180	187	3	3020	75		101	137	25.0	51	25.0	
SPB 190x5	190	197	3	3020	75		101	147	25.0	51	25.0	
SPB 200x5	200	207	3	3020	75		101	157	25.0	51	25.0	
SPB 212x5	212	219	3	3020	75		101	169	25.0	51	25.0	
SPB 224x5	224	231	3	3020	75		101	181	25.0	51	25.0	
SPB 236x5	236	243	3	3535	90		101	193	6.0	89	6.0	
SPB 250x5	250	257	3	3535	90		101	207	6.0	89	6.0	
SPB 280x5	280	287	6	3535	90	25	101	237	6.0	89	6.0	175
SPB 300x5	300	307	6	3535	90	25	101	257	6.0	89	6.0	175
SPB 315x5	315	322	6	3535	90	25	101	272	6.0	89	6.0	175
SPB 335x5	335	342	6	3535	90	25	101	292	6.0	89	6.0	175
SPB 355x5	355	362	6	3535	90	17	101	312	6.0	89	6.0	175
SPB 400x5	400	407	5	3535	90		101	357	6.0	89	6.0	175
SPB 450x5	450	457	5	3535	90		101	407		89	12.0	175
SPB 500x5	500	507	5	3535	90		101	457		89	12.0	175
SPB 560x5	560	567	4	4040	100		101	517		102	1.0	210
SPB 630x5	630	637	4	4040	100		101	587		102	1.0	210
SPB 710x5	710	717	4	4040	100		101	664		102	1.0	210
SPB 800x5	800	807	4	4040	100		101	754		102	1.0	210
SPB 900x5	900	907	4	4040	100		101	854		102	1.0	210
SPB 1000x5	1000	1007	4	4545	110		101	954	6.5	114	6.5	242
SPB 1250x5	1250	1257	4	4545	110		101	1204	6.5	114	6.5	242

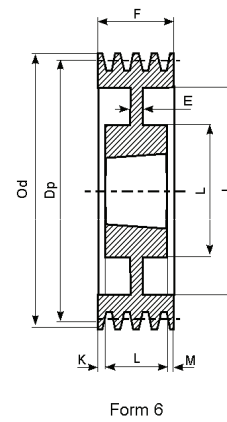
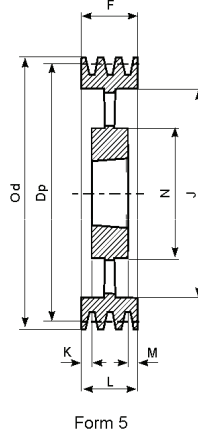
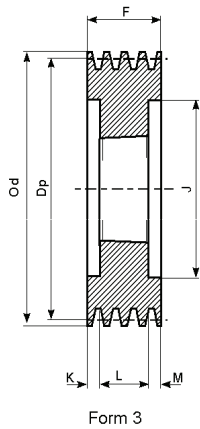

SPB - 6

Description	Dp.	Od.	Form	Bush No.	Max Bore	E	F	J	K	L	M	N
SPB 140x6	140	147	3	2517	60		120	100	37.5	45	37.5	
SPB 150x6	150	157	3	2517	60		120	107	37.5	45	37.5	
SPB 160x6	160	167	3	3020	75		120	117	34.5	51	34.5	
SPB 170x6	170	177	3	3020	75		120	127	34.5	51	34.5	
SPB 180x6	180	187	3	3020	75		120	137	34.5	51	34.5	
SPB 190x6	190	197	3	3020	75		120	147	34.5	51	34.5	
SPB 200x6	200	207	3	3020	75		120	157	34.5	51	34.5	
SPB 212x6	212	219	3	3535	90		120	169	15.5	89	15.5	
SPB 224x6	224	231	3	3535	90		120	181	15.5	89	15.5	
SPB 236x6	236	243	3	3535	90		120	193	15.5	89	15.5	
SPB 250x6	250	257	3	3535	90		120	207	15.5	89	15.5	
SPB 280x6	280	287	6	3535	90	25	120	237	15.5	89	15.5	175
SPB 300x6	300	307	6	3535	90	25	120	257	15.5	89	15.5	175
SPB 315x6	315	322	6	3535	90	25	120	272	15.5	89	15.5	175
SPB 335x6	335	342	6	3535	90	25	120	292	15.5	89	15.5	175
SPB 355x6	355	362	6	3535	90	25	120	312	15.5	89	15.5	175
SPB 400x6	400	407	5	3535	90		120	357	15.5	89	15.5	175
SPB 450x6	450	457	5	4040	100		120	407		102	18.0	210
SPB 500x6	500	507	5	4040	100		120	457		102	18.0	210
SPB 560x6	560	567	5	4040	100		120	517		102	18.0	210
SPB 630x6	630	637	5	4040	100		120	587		102	18.0	210
SPB 710x6	710	717	5	4040	100		120	664	9.0	102	9.0	210
SPB 800x6	800	807	5	4545	110		120	754	3.0	114	3.0	242
SPB 900x6	900	907	5	4545	110		120	854	3.0	114	3.0	242
SPB 1000x6	1000	1007	5	4545	110		120	954	3.0	114	3.0	242
SPB 1250x6	1250	1257	5	4545	110		120	1204	3.0	114	3.0	242

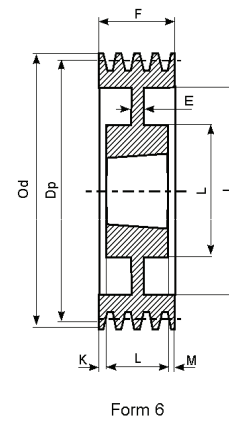
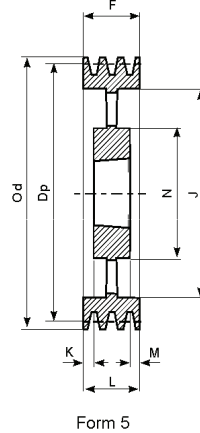
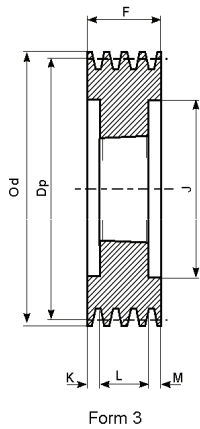

SPB - 8

Description	Dp.	Od.	Form	Bush No.	Max Bore	E	F	J	K	L	M	N
SPB 140x8	140	147	3	2517	60		158	97	37.5	45	37.5	
SPB 160x8	160	167	3	3020	75		158	117	53.5	51	53.5	
SPB 170x8	170	177	3	3030	75		158	127	41.0	76	41.0	
SPB 180x8	180	187	3	3030	75		158	137	41.0	76	41.0	
SPB 190x8	190	197	3	3030	75		158	147	41.0	76	41.0	
SPB 200x8	200	207	3	3535	90		158	157	34.5	89	34.5	
SPB 212x8	212	219	3	3535	90		158	169	34.5	89	34.5	
SPB 224x8	224	231	3	3535	90		158	181	34.5	89	34.5	
SPB 236x8	236	243	3	3535	90		158	193	34.5	89	34.5	
SPB 250x8	250	257	3	3535	90		158	207	34.5	89	34.5	
SPB 280x8	280	287	6	3535	90	25	158	237	34.5	89	34.5	175
SPB 300x8	300	307	6	3535	90	25	158	257	34.5	89	34.5	175
SPB 315x8	315	322	6	3535	90	25	158	272	34.5	89	34.5	175
SPB 335x8	335	342	6	3535	90	25	158	292	34.5	89	34.5	175
SPB 355x8	355	362	6	3535	90	25	158	312	34.5	89	34.5	175
SPB 400x8	400	407	6	4040	100	30	158	357	28.0	102	28.0	210
SPB 450x8	450	457	5	4040	100		158	407	28.0	102	28.0	210
SPB 500x8	500	507	5	4040	100		158	457	28.0	102	28.0	210
SPB 560x8	560	567	5	4545	110		158	517	22.0	114	22.0	242
SPB 630x8	630	637	5	4545	110		158	587	22.0	114	22.0	242
SPB 710x8	710	717	5	4545	110		158	664	22.0	114	22.0	242
SPB 800x8	800	807	5	4545	110		158	754	22.0	114	22.0	242
SPB 900x8	900	907	5	4545	110		158	854	22.0	114	22.0	242
SPB 1000x8	1000	1007	5	5050	110		158	954	15.5	127	15.5	267
SPB 1250x8	1250	1257	5	5050	110		158	1204	15.5	127	15.5	267

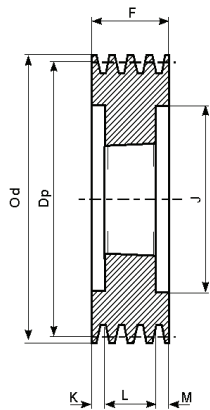

Form 3

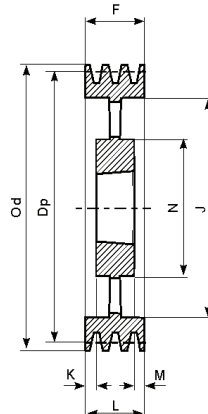

Form 5

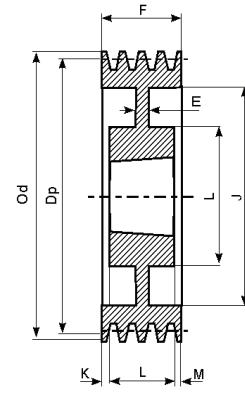

Form 6

SPB - 10

Description	Dp.	Od.	Form	Bush No.	Max Bore	E	F	J	K	L	M	N
SPB 224x10	224	231	3	3535	90		196	181	53.5	89	53.5	
SPB 236x10	236	243	3	3535	90		196	193	53.5	89	53.5	
SPB 250x10	250	257	3	3535	90		196	207	53.5	89	53.5	
SPB 280x10	280	287	6	3535	90	30	196	237	53.5	89	53.5	175
SPB 315x10	315	322	6	3535	90	30	196	272	53.5	89	53.5	175
SPB 335x10	335	342	6	4040	100	30	196	292	47.0	102	47.0	210
SPB 355x10	355	362	6	4040	100	30	196	312	47.0	102	47.0	210
SPB 400x10	400	407	6	4040	100	30	196	357	47.0	102	47.0	210
SPB 450x10	450	457	5	4545	110		196	407	41.0	114	41.0	242
SPB 500x10	500	507	5	4545	110		196	457	41.0	114	41.0	242
SPB 560x10	560	567	5	4545	110		196	517	41.0	114	41.0	242
SPB 630x10	630	637	5	4545	110		196	587	41.0	114	41.0	242
SPB 710x10	710	717	5	4545	110		196	664	41.0	114	41.0	242
SPB 800x10	800	807	5	4545	110		196	754	41.0	114	41.0	242
SPB 900x10	900	907	5	5050	125		196	854	34.5	127	34.5	267
SPB 1000x10	1000	1007	5	5050	125		196	954	34.5	127	34.5	267
SPB 1250X10	1250	1257	5	5050	125		196	1204	34.5	127	34.5	267

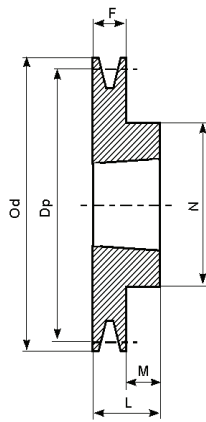

Form 1

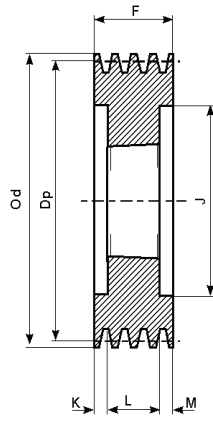

Form 3

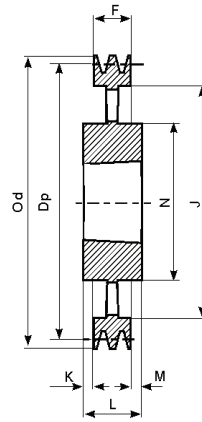

Form 4

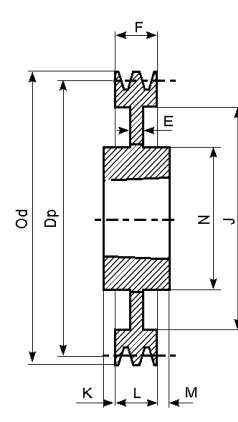

Form 7

SPC - 3

Description	Dp.	Od.	Form	Bush No.	Max Bore	E	F	J	K	L	M	N
SPC 200x3	200	209.6	3	2517	60		85	144	20.0	45	20.0	
SPC 212x3	212	221.6	3	3020	75		85	156	17.0	51	17.0	
SPC 224x3	224	233.6	3	3020	75		85	168	17.0	51	17.0	
SPC 236x3	236	245.6	3	3020	75		85	180	17.0	51	17.0	
SPC 250x3	250	259.6	3	3020	75		85	194	17.0	51	17.0	
SPC 265x3	265	274.6	1	3535	90		85	209		89	4.0	175
SPC 280x3	280	289.6	1	3535	90		85	224		89	4.0	175
SPC 300x3	300	309.6	7	3535	90	20	85	244	2.0	89	2.0	175
SPC 315x3	315	324.6	7	3535	90	20	85	259	2.0	89	2.0	175
SPC 335x3	335	344.6	7	3535	90	20	85	279	2.0	89	2.0	175
SPC 355x3	355	364.6	7	3535	90	20	85	299	2.0	89	2.0	175
SPC 375x3	375	384.6	7	3535	90	25	85	319	2.0	89	2.0	175
SPC 400x3	400	409.6	7	3535	90	17	85	344	2.0	89	2.0	175
SPC 425x3	425	434.6	7	3535	90	17	85	369	2.0	89	2.0	175
SPC 450x3	450	459.6	4	3535	90		85	394	2.0	89	2.0	175
SPC 475x3	475	484.6	4	3535	90		85	419	2.0	89	2.0	175
SPC 500x3	500	509.6	4	3535	90		85	444	2.0	89	2.0	175
SPC 530x3	530	539.6	4	3535	90		85	474	2.0	89	2.0	175
SPC 560x3	560	569.6	4	3535	90		85	504	2.0	89	2.0	175
SPC 630x3	630	639.6	4	4040	100		85	574	8.5	102	8.5	210
SPC 800x3	800	809.6	4	4545	110		85	737	14.5	114	14.5	242
SPC 1000x3	1000	1009.6	4	5050	125		85	937	21.0	127	21.0	267
SPC 1250x3	1250	1259.6	4	5050	125		85	1187	21.0	127	21.0	267

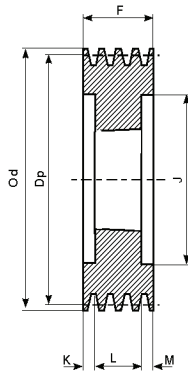

Form 3

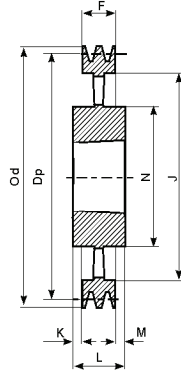

Form 4

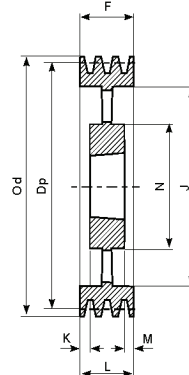

Form 5

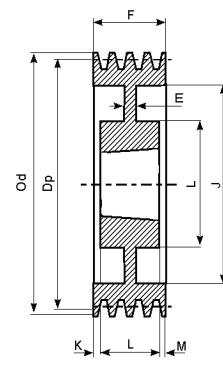

Form 6

SPC - 4

Description	Dp.	Od.	Form	Bush No.	Max Bore	E	F	J	K	L	M	N
SPC 200x4	200	209.6	3	3020	75		111	144	30.0	51	30.0	
SPC 212x4	212	221.6	3	3020	75		111	156	30.0	51	30.0	
SPC 224x4	224	233.6	3	3535	90		111	168	11.0	89	11.0	
SPC 236x4	236	245.6	3	3535	90		111	180	11.0	89	11.0	
SPC 250x4	250	259.6	3	3535	90		111	194	11.0	89	11.0	
SPC 265x4	265	274.6	3	3535	90		111	209	11.0	89	11.0	
SPC 280x4	280	289.6	6	3535	90	18	111	224	11.0	89	11.0	175
SPC 300x4	300	309.6	6	3535	90	20	111	244	11.0	89	11.0	175
SPC 315x4	315	324.6	6	3535	90	20	111	259	11.0	89	11.0	175
SPC 335x4	335	344.6	6	3535	90	20	111	279	11.0	89	11.0	175
SPC 355x4	355	364.6	6	3535	90	20	111	299	11.0	89	11.0	175
SPC 375x4	375	384.6	6	3535	90	25	111	319	11.0	89	11.0	175
SPC 400x4	400	409.6	6	3535	90	18	111	344	11.0	89	11.0	175
SPC 425x4	425	434.6	6	3535	90	18	111	369	11.0	89	11.0	175
SPC 450x4	450	459.6	5	3535	90		111	394	11.0	89	11.0	175
SPC 475x4	475	484.6	5	3535	90		111	419	11.0	89	11.0	175
SPC 500x4	500	509.6	5	3535	90		111	444	11.0	89	11.0	175
SPC 530x4	530	539.6	5	4040	100		111	474	4.5	102	4.5	210
SPC 560x4	560	569.6	5	4040	100		111	504	4.5	102	4.5	210
SPC 630x4	630	639.6	4	4545	110		111	574	1.5	114	1.5	242
SPC 710x4	710	719.6	4	5050	125		111	654	8.0	127	8.0	267
SPC 800x4	800	809.6	4	5050	125		111	737	8.0	127	8.0	267
SPC 1000x4	1000	1009.6	4	5050	125		111	937	8.0	127	8.0	267
SPC 1250x4	1250	1259.6	4	5050	125		111	1187	8.0	127	8.0	267

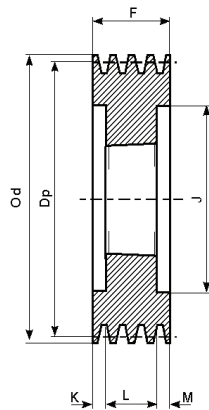

Form 3

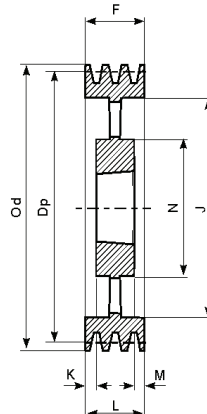

Form 5

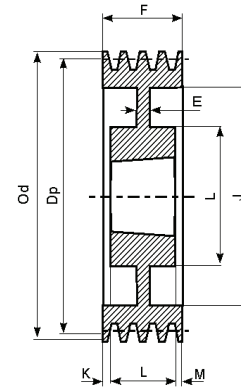

Form 6

SPC - 5

Description	Dp.	Od.	Form	Bush No.	Max Bore	E	F	J	K	L	M	N
SPC 200x5	200	209.6	3	3535	90		136	144	23.5	89	23.5	
SPC 212x5	212	221.6	3	3535	90		136	156	23.5	89	23.5	
SPC 224x5	224	233.6	3	3535	90		136	168	23.5	89	23.5	
SPC 236x5	236	245.6	3	3535	90		136	180	23.5	89	23.5	
SPC 250x5	250	259.6	3	3535	90		136	194	23.5	89	23.5	
SPC 265x5	265	274.6	3	3535	90		136	209	23.5	89	23.5	
SPC 280x5	280	289.6	3	3535	90		136	224	23.5	89	23.5	
SPC 300x5	300	309.6	6	3535	90	20	136	244	23.5	89	23.5	175
SPC 315x5	315	324.6	6	3535	90	20	136	259	23.5	89	23.5	175
SPC 335x5	335	344.6	6	3535	90	20	136	279	23.5	89	23.5	175
SPC 355x5	355	364.6	6	3535	90	20	136	299	23.5	89	23.5	175
SPC 375x5	375	384.6	6	3535	90	25	136	319	23.5	89	23.5	175
SPC 400x5	400	409.6	6	3535	90	15	136	344	23.5	89	23.5	175
SPC 425x5	425	434.6	6	3535	90	20	136	369	23.5	89	23.5	175
SPC 450x5	450	459.6	5	4040	100		136	394	17.0	102	17.0	210
SPC 475x5	475	484.6	5	4040	100		136	419	17.0	102	17.0	210
SPC 500x5	500	509.6	5	4040	100		136	444	17.0	102	17.0	210
SPC 530x5	530	539.6	5	4545	110		136	474	11.0	114	11.0	240
SPC 560x5	560	569.6	5	4545	110		136	504	11.0	114	11.0	242
SPC 630x5	630	639.6	5	5050	125		136	574	4.5	127	4.5	267
SPC 710x5	710	719.6	5	5050	125		136	654	4.5	127	4.5	267
SPC 800x5	800	809.6	5	5050	125		136	737	4.5	127	4.5	267
SPC 1000x5	1000	1009.6	5	5050	125		136	937	4.5	127	4.5	267
SPC 1250x5	1250	1259.6	5	5050	125		136	1187	4.5	127	4.5	267

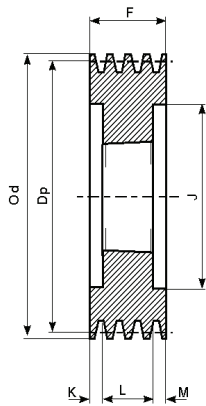

Form 3

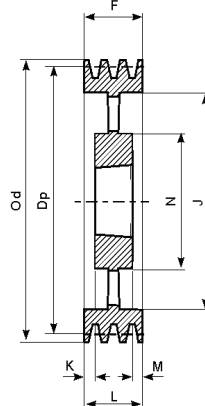

Form 5

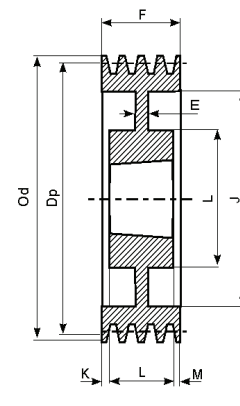

Form 6

SPC - 6

Description	Dp.	Od.	Form	Bush No.	Max Bore	E	F	J	K	L	M	N
SPC 200x6	200	209.6	3	3535	90		162	144	36.5	89	36.5	
SPC 212x6	212	221.6	3	3535	90		162	156	36.5	89	36.5	
SPC 224x6	224	233.6	3	3535	90		162	168	36.5	89	36.5	
SPC 236x6	236	245.6	3	3535	90		162	180	36.5	89	36.5	
SPC 250x6	250	259.6	3	3535	90		162	194	36.5	89	36.5	
SPC 265x6	265	274.6	3	3535	90		162	209	36.5	89	36.5	
SPC 280x6	280	289.6	6	3535	90	20	162	224	36.5	89	36.5	175
SPC 300x6	300	309.6	6	3535	90	20	162	244	36.5	89	36.5	175
SPC 315x6	315	324.6	6	3535	90	20	162	259	36.5	89	36.5	175
SPC 335x6	335	344.6	6	3535	90	20	162	279	36.5	89	36.5	175
SPC 355x6	355	364.6	6	3535	90	20	162	299	36.5	89	36.5	175
SPC 375x6	375	384.6	6	4040	100	30	162	319	30.0	102	30.0	210
SPC 400x6	400	409.6	6	4040	100	30	162	344	30.0	102	30.0	210
SPC 425x6	425	434.6	6	4040	100	30	162	369	30.0	102	30.0	210
SPC 450x6	450	459.6	6	4545	110	30	162	394	24.0	114	24.0	242
SPC 475x6	475	484.6	6	4545	110	30	162	419	24.0	114	24.0	242
SPC 500x6	500	509.6	5	4545	110		162	444	24.0	114	24.0	242
SPC 530x6	530	539.6	5	5050	125		162	474	17.5	127	17.5	265
SPC 560x6	560	569.6	5	5050	125		162	504	17.5	127	17.5	267
SPC 630x6	630	639.6	5	5050	125		162	574	17.5	127	17.5	267
SPC 710x6	710	719.6	5	5050	125		162	654	17.5	127	17.5	267
SPC 800x6	800	809.6	5	5050	125		162	737	17.5	127	17.5	267
SPC 1000x6	1000	1009.6	5	5050	125		162	937	17.5	127	17.5	267
SPC 1250x6	1250	1259.6	5	5050	125		162	1187	17.5	127	17.5	267

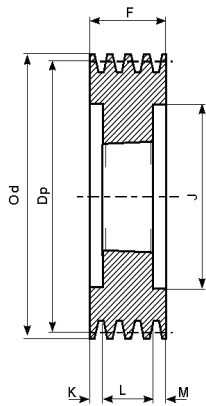

Form 3

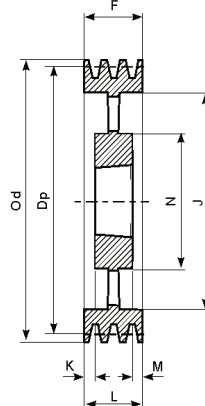

Form 5

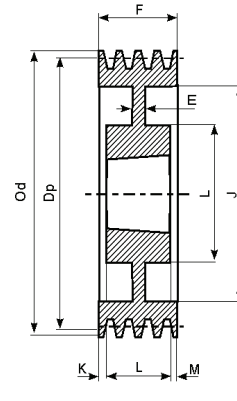

Form 6

SPC - 8

Description	Dp.	Od.	Form	Bush No.	Max Bore	E	F	J	K	L	M	N
SPC 200x8	200	209.6	3	3535	90		213	144	62.0	89	62.0	
SPC 212x8	212	221.6	3	3535	90		213	156	62.0	89	62.0	
SPC 224x8	224	233.6	3	3535	90		213	168	62.0	89	62.0	
SPC 236x8	236	245.6	3	3535	90		213	180	62.0	89	62.0	
SPC 250x8	250	259.6	3	3535	90		213	194	62.0	89	62.0	
SPC 265x8	265	274.6	3	3535	90		213	209	62.0	89	62.0	
SPC 280x8	280	289.6	3	3535	90		213	224	62.0	89	62.0	
SPC 300x8	300	309.6	3	4040	100		213	244	55.5	102	55.5	
SPC 315x8	315	324.6	3	4040	100		213	259	55.5	102	55.5	
SPC 335x8	335	344.6	6	4040	100	50	213	279	55.5	102	55.5	210
SPC 355x8	355	364.6	6	4040	100	40	213	299	55.5	102	55.5	210
SPC 375x8	375	384.6	6	4545	110	30	213	319	49.5	114	49.5	242
SPC 400x8	400	409.6	6	4545	110	30	213	344	49.5	114	49.5	242
SPC 425x8	425	434.6	6	4545	110	30	213	369	49.5	114	49.5	240
SPC 450x8	450	459.6	6	5050	125	30	213	394	43.0	127	43.0	267
SPC 475x8	475	484.6	6	5050	125	30	213	419	43.0	127	43.0	267
SPC 500x8	500	509.6	6	5050	125	30	213	444	43.0	127	43.0	267
SPC 530x8	530	539.6	6	5050	125	30	213	474	43.0	127	43.0	267
SPC 560x8	560	569.6	5	5050	125		213	504	43.0	127	43.0	267
SPC 630x8	630	639.6	5	5050	125		213	574	43.0	127	43.0	267
SPC 710x8	710	719.6	5	5050	125		213	654	43.0	127	43.0	267
SPC 800x8	800	809.6	5	5050	125		213	737	43.0	127	43.0	267
SPC 1000x8	1000	1009.6	5	5050	125		213	937	43.0	127	43.0	267
SPC 1250x8	1250	1259.6	5	5050	125		213	1187	43.0	127	43.0	267

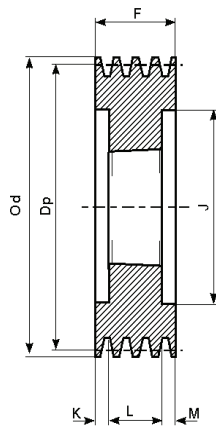

Form 3

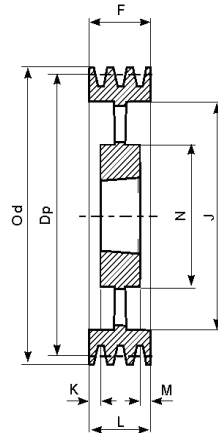

Form 5

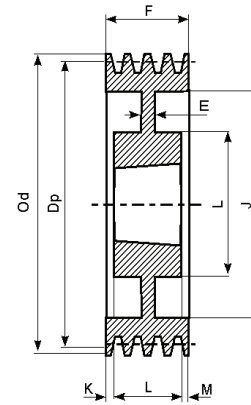

Form 6

SPC - 10

Description	Dp.	Od.	Form	Bush No.	Max Bore	E	F	J	K	L	M	N
SPC 250x10	250	259.6	3	4040	100		264	194	81.0	102	81.0	
SPC 280x10	280	289.6	3	4040	100		264	224	81.0	102	81.0	
SPC 300x10	300	309.6	3	4545	110		264	244	75.0	114	75.0	
SPC 315x10	315	324.6	3	4545	110		264	259	75.0	114	75.0	
SPC 355x10	355	364.6	3	4545	110		264	299	75.0	114	75.0	
SPC 400x10	400	409.6	6	5050	125	70	264	344	68.5	127	68.5	267
SPC 450x10	450	459.6	6	5050	125	40	264	394	68.5	127	68.5	267
SPC 500x10	500	509.6	6	5050	125	40	264	444	68.5	127	68.5	267
SPC 560x10	560	569.6	5	5050	125		264	504	68.5	127	68.5	267
SPC 630x10	630	639.6	5	5050	125		264	574	68.5	127	68.5	267
SPC 710x10	710	719.6	5	5050	125		264	654	68.5	127	68.5	267
SPC 800x10	800	809.6	5	5050	125		264	737	68.5	127	68.5	267
SPC 1000x10	1000	1009.6	5	5050	125		264	937	68.5	127	68.5	267
SPC 1250x10	1250	1259.6	5	5050	125		264	1187	68.5	127	68.5	267

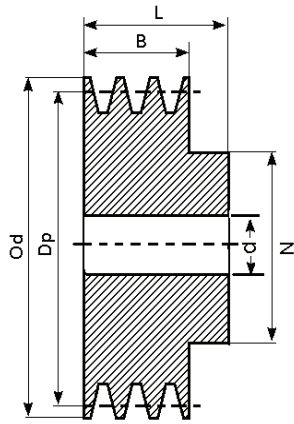

Form 1

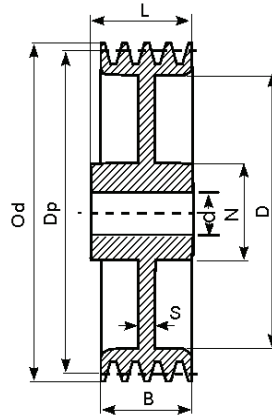

Form 3

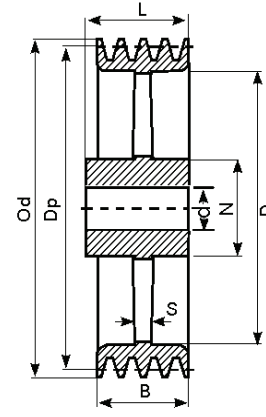

Form 5

SPZ - 1

Description	Od	Dp	Form	N	L	J	E	B	d
SPZ 50x1	54	50	1	40	28			16	10
SPZ 56x1	60	56	1	45	28			16	10
SPZ 63x1	67	63	1	50	28			16	10
SPZ 71x1	75	71	1	50	28			16	10
SPZ 75x1	79	75	1	50	28			16	10
SPZ 80x1	84	80	1	50	28			16	10
SPZ 85x1	89	85	1	50	28			16	10
SPZ 90x1	94	90	1	50	28			16	10
SPZ 95x1	99	95	1	50	28			16	10
SPZ 100x1	104	100	1	50	28			16	10
SPZ 106x1	110	106	1	50	28			16	10
SPZ 112x1	116	112	1	50	28			16	10
SPZ 118x1	122	118	3	50	28	93	8	16	10
SPZ 125x1	129	125	3	50	28	100	8	16	15
SPZ 132x1	136	132	3	50	28	106	8	16	15
SPZ 140x1	144	140	3	50	28	114	8	16	15
SPZ 150x1	154	150	3	50	28	124	8	16	15
SPZ 160x1	164	160	3	55	32	134	8	16	15
SPZ 180x1	184	180	5	55	32	154	8	16	20
SPZ 200x1	204	200	5	55	32	174	8	16	20
SPZ 224x1	228	224	5	55	32	198	8	16	20
SPZ 250x1	254	250	5	55	32	224	8	16	20

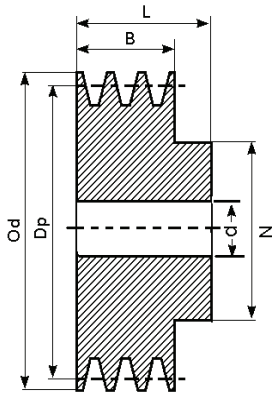

Form 1

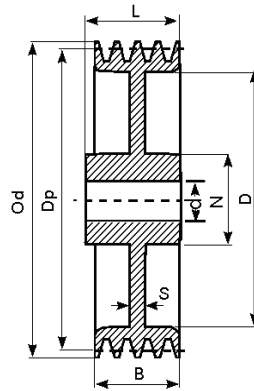

Form 3

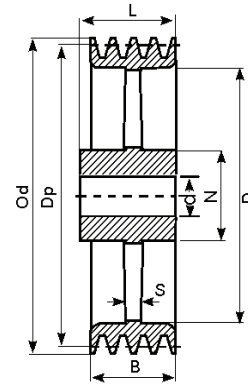

Form 5

SPZ - 2

Description	Od	Dp	Form	N	L	J	E	B	d
SPZ 50x2	54	50	1	40	35			28	10
SPZ 56x2	60	56	1	45	35			28	10
SPZ 63x2	67	63	1	50	35			28	10
SPZ 71x2	75	71	1	55	35			28	10
SPZ 75x2	79	75	1	60	35			28	10
SPZ 80x2	84	80	1	60	35			28	10
SPZ 85x2	89	85	1	60	35			28	10
SPZ 90x2	94	90	1	60	35			28	10
SPZ 95x2	99	95	1	60	35			28	15
SPZ 100x2	104	100	1	60	35			28	15
SPZ 106x2	110	106	1	60	35			28	15
SPZ 112x2	116	112	1	60	35			28	15
SPZ 118x2	122	118	3	60	35	97	8	28	15
SPZ 125x2	129	125	3	60	35	99	8	28	15
SPZ 132x2	136	132	3	60	40	105	8	28	15
SPZ 140x2	144	140	3	60	40	114	8	28	15
SPZ 150x2	154	150	3	60	40	124	8	28	15
SPZ 160x2	164	160	3	60	40	134	8	28	15
SPZ 180x2	184	180	5	60	40	154	8	28	20
SPZ 200x2	204	200	5	60	40	174	8	28	20
SPZ 224x2	228	224	5	60	40	198	8	28	20
SPZ 250x2	254	250	5	60	40	224	10	28	20
SPZ 280x2	284	280	5	65	45	254	10	28	20
SPZ 315x2	319	315	5	65	45	289	10	28	20

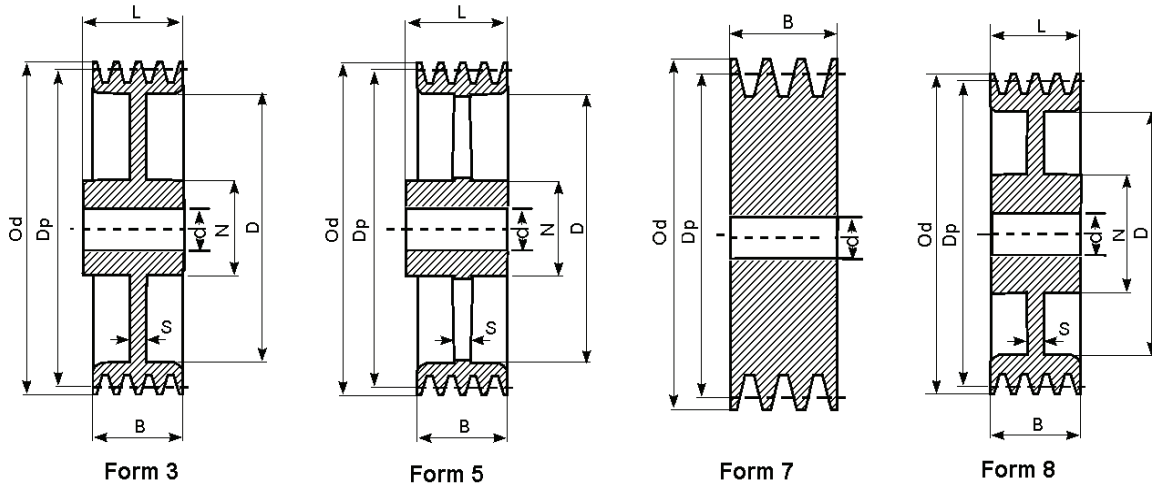

SPZ - 3

Description	Od	Dp	Form	N	L	J	E	B	d
SPZ 50x3	54	50	7					40	10
SPZ 56x3	60	56	7					40	10
SPZ 63x3	67	63	7					40	10
SPZ 71x3	75	71	7					40	10
SPZ 75x3	79	75	7					40	10
SPZ 80x3	84	80	7					40	10
SPZ 85x3	89	85	7					40	15
SPZ 90x3	94	90	7					40	15
SPZ 95x3	99	95	7					40	15
SPZ 100x3	104	100	7					40	15
SPZ 106x3	110	106	7					40	15
SPZ 112x3	116	112	7					40	15
SPZ 118x3	122	118	7					40	15
SPZ 125x3	129	125	7					40	15
SPZ 132x3	136	132	8	60		106	8	40	15
SPZ 140x3	140	140	8	60		114	8	40	15
SPZ 150x3	154	150	8	60	40	124	8	40	20
SPZ 160x3	164	160	3	65	45	134	8	40	20
SPZ 180x3	184	180	5	65	45	154	8	40	20
SPZ 200x3	204	200	5	65	45	174	10	40	20
SPZ 224x3	228	224	5	65	45	198	10	40	20
SPZ 250x3	254	250	5	65	45	224	12	40	20

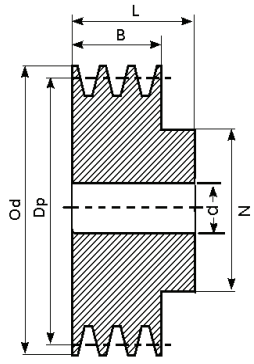

Form 1

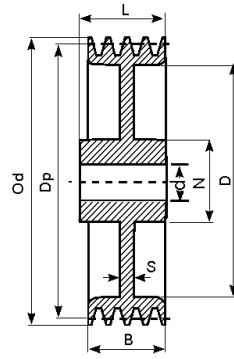

Form 3

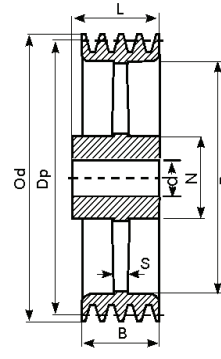

Form 5

SPA - 1

Description	Od	Dp	Form	N	L	J	E	B	d
SPA 40x1	45.5	40	1	40	35			20	10
SPA 50x1	55.5	50	1	40	35			20	10
SPA 60x1	65.5	60	1	40	35			20	10
SPA 71x1	76.5	71	1	40	40			20	10
SPA 75x1	80.5	75	1	40	40			20	10
SPA 80x1	85.5	80	1	45	40			20	10
SPA 85x1	90.5	85	1	45	40			20	10
SPA 90x1	95.5	90	1	45	40			20	10
SPA 95x1	100.5	95	1	45	40			20	10
SPA 100x1	105.5	100	1	50	40			20	10
SPA 106x1	111.5	106	1	48	40			20	10
SPA 112x1	117.5	112	1	48	40			20	10
SPA 118x1	123.5	118	1	60	40			20	15
SPA 132x1	137.5	132	1	60	40			20	15
SPA 140x1	145.5	140	3	60	40	107	10	20	15
SPA 150x1	155.5	150	3	60	40	117	10	20	15
SPA 160x1	165.5	160	3	60	40	127	10	20	15
SPA 170x1	175.5	170	3	60	40	137	12	20	15
SPA 180x1	185.5	180	3	65	40	147	12	20	20
SPA 200x1	205.5	200	3	65	45	167	12	20	20
SPA 224x1	229.5	224	3	65	45	192	12	20	20
SPA 250x1	255.5	250	3	75	50	217	12	20	20
SPA 280x1	285.5	280	5	75	50	247	14	20	20
SPA 300x1	305.5	300	5	75	50	267	14	20	20
SPA 315x1	320.5	315	5	75	50	282	14	20	20
SPA 355x1	360.5	355	5	75	50	322	14	20	20
SPA 400x1	405.5	400	5	90	50	367	14	20	20
SPA 450x1	455.5	450	5	90	50	417	14	20	20

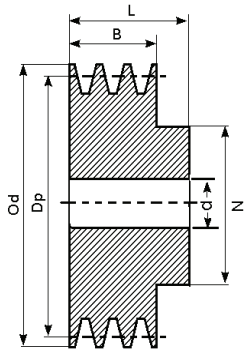

Form 1

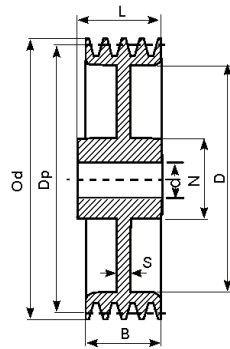

Form 3

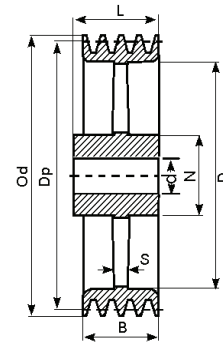

Form 5

SPA - 2

Description	Od	Dp	Form	N	L	J	E	B	d
SPA 50x2	55.5	50	1	40	45			35	10
SPA 60x2	65.5	60	1	40	45			35	10
SPA 71x2	76.5	71	1	50	45			35	10
SPA 75x2	80.5	75	1	50	45			35	10
SPA 80x2	85.5	80	1	50	45			35	10
SPA 85x2	90.5	85	1	50	45			35	10
SPA 90x2	95.5	90	1	60	45			35	15
SPA 95x2	100.5	95	1	60	45			35	15
SPA 100x2	105.5	100	1	60	45			35	15
SPA 106x2	111.5	106	1	60	45			35	15
SPA 112x2	116.5	112	1	60	45			35	15
SPA 118x2	123.5	118	1	60	45			35	15
SPA 132x2	137.5	132	1	60	45			35	15
SPA 140x2	145.5	140	3	60	45	107	10	35	15
SPA 150x2	155.5	150	3	60	45	117	10	35	15
SPA 160x2	165.5	160	3	60	45	127	10	35	15
SPA 170x2	175.5	170	3	60	45	137	12	35	15
SPA 180x2	185.5	180	3	70	50	147	12	35	20
SPA 200x2	205.5	200	3	70	50	167	12	35	20
SPA 224x2	229.5	224	3	70	50	192	12	35	20
SPA 250x2	255.5	250	3	75	50	217	12	35	20
SPA 280x2	285.5	280	5	80	50	247	14	35	20
SPA 300x2	305.5	300	5	80	50	267	14	35	20
SPA 315x2	320.5	315	5	80	60	282	14	35	20
SPA 355x2	360.5	355	5	80	50	322	14	35	20
SPA 400x2	405.5	400	5	90	50	367	14	35	20
SPA 450x2	455.5	450	5	100	50	417	14	35	25
SPA 500x2	505.5	500	5	100	60	467	16	35	25
SPA 560x2	565.5	560	5	100	50	527	20	35	25
SPA 600x2	605.5	600	5	110	50	567	20	35	25
SPA 630x2	635.5	630	5	110	50	597	20	35	25

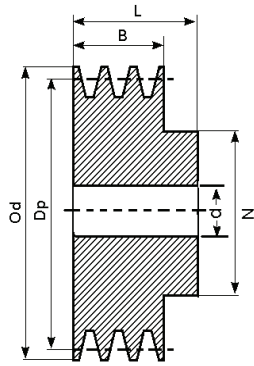

Form 1

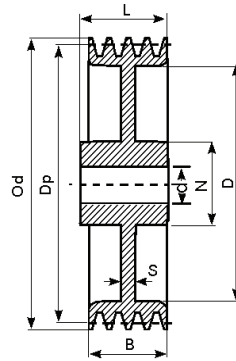

Form 3

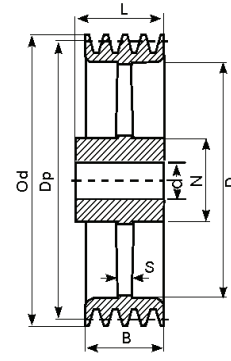

Form 5

SPA - 3

Description	Od	Dp	Form	N	L	J	E	B	d
SPA 60x3	65.5	60	1					50	10
SPA 71x3	76.5	71	1	52	52			50	10
SPA 75x3	80.5	75	1					50	10
SPA 80x3	85.5	80	1					50	15
SPA 85x3	90.5	85	1					50	15
SPA 90x3	95.5	90	1					50	15
SPA 95x3	100.5	95	1					50	15
SPA 100x3	105.5	100	1					50	15
SPA 112x3	117.5	112	1					50	15
SPA 118x3	133.5	118	1					50	15
SPA 132x3	137.5	132	1					50	15
SPA 140x3	145.5	140	3	65	52	107	12	50	15
SPA 150x3	155.5	150	3	65	52	117	12	50	20
SPA 160x3	165.5	160	3	70	52	127	12	50	20
SPA 170x3	175.5	170	3	70	52	137	12	50	20
SPA 180x3	185.5	180	3	70	52	147	12	50	20
SPA 200x3	205.5	200	3	70	52	167	12	50	20
SPA 224x3	229.5	224	3	80	52	192	12	50	20
SPA 250x3	255.5	250	3	80	60	217	12	50	20
SPA 280x3	285.5	280	5	80	60	247	14	50	20
SPA 300x3	305.5	300	5	80	60	267	14	50	20
SPA 315x3	320.5	315	5	90	60	282	14	50	20
SPA 355x3	360.5	355	5	90	60	322	14	50	20
SPA 400x3	405.5	400	5	100	60	367	16	50	25
SPA 450x3	455.5	450	5	100	60	417	16	50	25
SPA 500x3	505.5	500	5	105	60	467	20	50	25
SPA 560x3	565.5	560	5	120	65	527	20	50	25
SPA 600x3	605.5	600	5	120	65	567	20	50	25
SPA 630x3	635.5	630	5	120	65	597	20	50	25

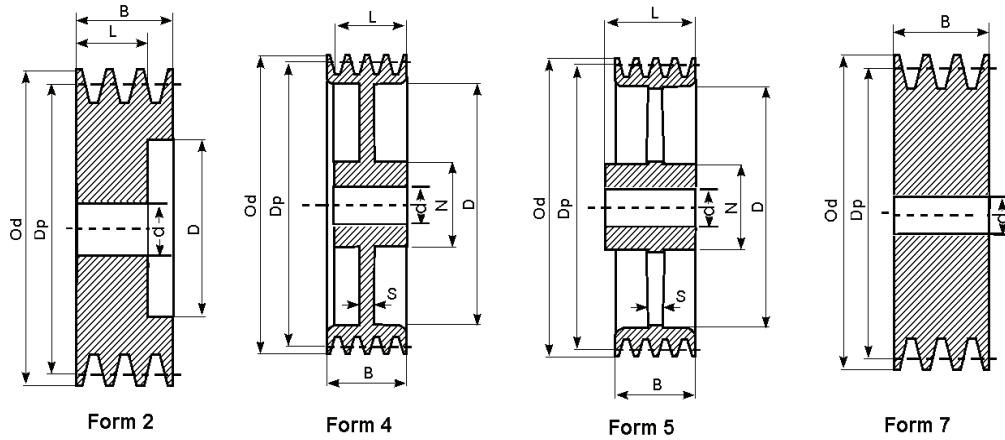

SPA - 4

Description	Od	Dp	Form	N	L	J	E	B	d
SPA 75x4	80.5	75	7					65	10
SPA 80x4	85.5	80	7					65	15
SPA 85x4	90.5	85	7					65	15
SPA 90x4	95.5	90	7					65	15
SPA 95x4	100.5	95	7					65	15
SPA 100x4	105.5	100	2		52	67		65	15
SPA 112x4	117.5	112	2		52	79		65	15
SPA 118x4	123.5	118	2		52	87		65	15
SPA 132x4	137.5	132	2		52	97		65	15
SPA 140x4	145.5	140	2		52	107		65	20
SPA 150x4	155.5	150	2		52	117		65	20
SPA 160x4	165.5	160	4	70	52	127	18	65	20
SPA 170x4	175.5	170	4	80	52	137	18	65	20
SPA 180x4	185.5	180	4	80	60	147	18	65	20
SPA 200x4	205.5	200	4	80	60	167	18	65	20
SPA 224x4	229.5	224	4	90	60	192	18	65	20
SPA 250x4	255.5	250	5	90	65	217	18	65	20
SPA 280x4	285.5	280	5	90	65	247	14	65	20
SPA 300x4	305.5	300	5	90	65	267	14	65	20
SPA 315x4	320.5	315	5	90	65	282	14	65	20
SPA 355x4	360.5	355	5	90	65	322	16	65	25
SPA 400x4	405.5	400	5	100	65	367	20	65	25
SPA 450x4	455.5	450	5	105	65	417	20	65	25
SPA 500x4	505.5	500	5	105	65	467	20	65	25
SPA 560x4	565.5	560	5	120	80	527	24	65	25
SPA 600x4	605.5	600	5	120	80	567	24	65	25
SPA 630x4	635.5	630	5	120	80	597	24	65	25

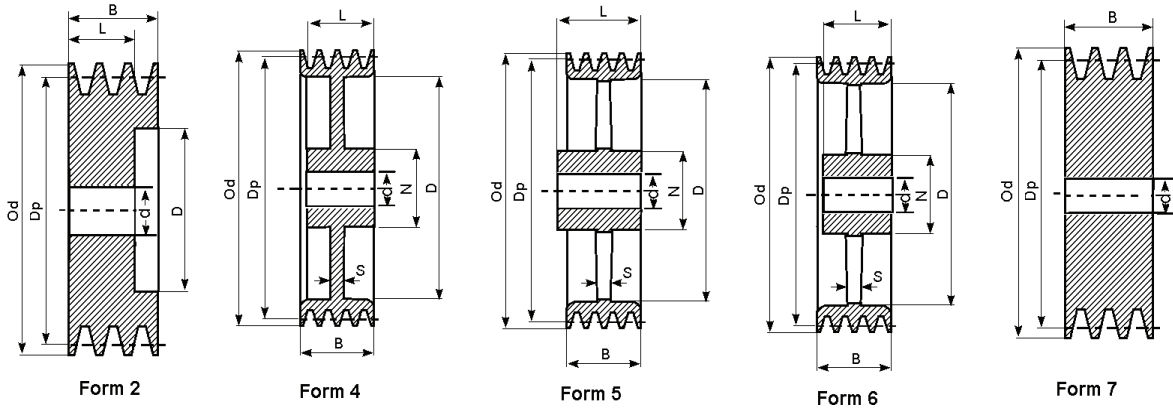

SPA - 5

Description	Od	Dp	Form	N	L	J	E	B	d
SPA 75x5	80.5	75	7					80	10
SPA 80x5	85.5	80	7					80	15
SPA 85x5	90.5	85	7					80	15
SPA 90x5	95.5	90	7					80	15
SPA 95x5	100.5	95	7					80	15
SPA 100x5	105.5	100	2		52	67		80	15
SPA 112x5	117.5	112	2		52	79		80	15
SPA 118x5	123.5	118	2		52	87		80	15
SPA 132x5	137.5	132	2		52	97		80	15
SPA 140x5	145.5	140	2		52	107		80	20
SPA 150x5	155.5	150	2		52	117		80	20
SPA 160x5	165.5	160	4	80	52	127	18	80	20
SPA 170x5	175.5	170	4	80	52	137	18	80	20
SPA 180x5	185.5	180	4	80	65	147	18	80	20
SPA 200x5	205.5	200	4	80	65	167	18	80	20
SPA 224x5	229.5	224	4	90	65	192	18	80	20
SPA 250x5	255.5	250	4	90	65	217	18	80	20
SPA 280x5	285.5	280	6	100	65	247	14	80	25
SPA 300x5	305.5	300	6	100	65	267	14	80	25
SPA 315x5	320.5	315	6	100	65	282	16	80	25
SPA 355x5	360.5	355	6	100	65	322	18	80	25
SPA 400x5	405.5	400	6	100	65	367	22	80	25
SPA 450x5	455.5	450	6	105	65	417	22	80	25
SPA 500x5	505.5	500	6	110	65	467	22	80	25
SPA 560x5	565.5	560	5	120	80	527	24	80	25
SPA 600x5	605.5	600	5	120	80	567	24	80	25
SPA 630x5	635.5	630	5	120	80	597	24	80	25

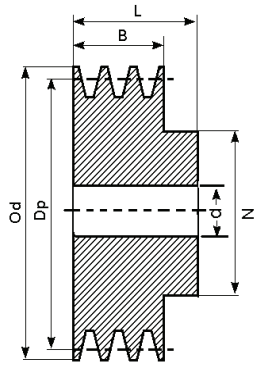

Form 1

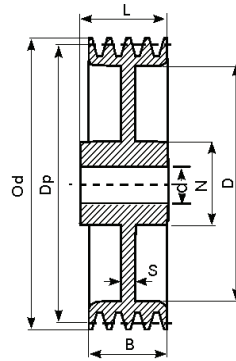

Form 3

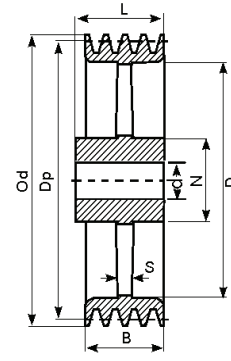

Form 5

SPB - 1

Description	Od	Dp	Form	N	L	J	E	B	d
SPB 70x1	77	70	1	45	45			25	10
SPB 80x1	87	80	1	50	45			25	10
SPB 95x1	97	90	1	50	45			25	10
SPB 100x1	107	100	1	52	45			25	10
SPB 112x1	119	112	1	55	45			25	15
SPB 120x1	127	120	1	55	45			25	15
SPB 125x1	132	125	1	58	45			25	15
SPB 132x1	139	132	1	60	45			25	15
SPB 140x1	147	140	1	65	45			25	20
SPB 150x1	157	150	1	65	45			25	20
SPB 160x1	167	160	3	65	45	118	12	25	20
SPB 170x1	177	170	3	65	45	128	12	25	20
SPB 180x1	187	180	3	65	45	138	12	25	20
SPB 200x1	207	200	3	70	45	158	14	25	20
SPB 212x1	219	212	3	70	45	170	14	25	20
SPB 225x1	232	225	3	70	45	183	14	25	20
SPB 250x1	257	250	3	70	50	208	14	25	20
SPB 280x1	287	280	3	76	50	238	14	25	20
SPB 300x1	307	300	5	76	50	258	15	25	20
SPB 315x1	322	315	5	76	50	273	15	25	20
SPB 355x1	362	355	5	80	50	313	15	25	20
SPB 400x1	407	400	5	85	55	358	18	25	20
SPB 450x1	457	450	5	90	60	408	18	25	20
SPB 500x1	507	500	5	100	60	458	18	25	25
SPB 560x1	567	560	5	100	60	518	18	25	25
SPB 600x1	607	600	5	100	60	558	18	25	25
SPB 630x1	637	630	5	100	60	588	18	25	25

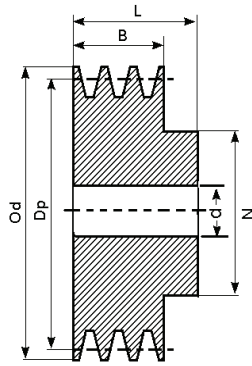

Form 1

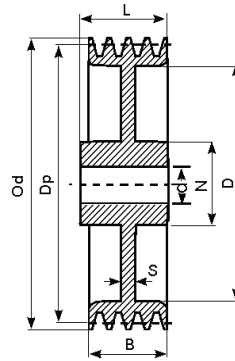

Form 3

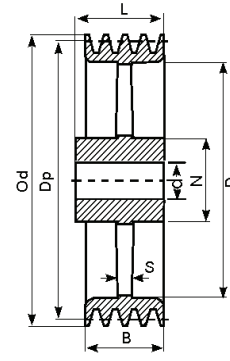

Form 5

SPB - 2

Description	Od	Dp	Form	N	L	J	E	B	d
SPB 70x2	77	70	1	45	48			44	10
SPB 80x2	87	80	1	50	48			44	10
SPB 95x2	97	90	1	50	49			44	10
SPB 100x2	107	100	1	55	55			44	15
SPB 112x2	119	112	1	60	55			44	15
SPB 120x2	127	120	1	60	55			44	15
SPB 125x2	132	125	1	60	55			44	15
SPB 132x2	139	132	1	60	55			44	15
SPB 140x2	147	140	1	65	55			44	20
SPB 150x2	157	150	1	65	55			44	20
SPB 160x2	167	160	3	70	55	118	12	44	20
SPB 170x2	177	170	3	70	55	128	12	44	20
SPB 180x2	187	180	3	70	55	138	12	44	20
SPB 200x2	207	200	3	70	55	158	14	44	20
SPB 212x2	219	212	3	77	55	170	14	44	20
SPB 225x2	232	225	3	77	55	183	14	44	20
SPB 250x2	257	250	3	77	55	208	14	44	20
SPB 280x2	287	280	3	80	55	238	14	44	20
SPB 300x2	307	300	5	80	55	258	15	44	20
SPB 315x2	322	315	5	80	60	273	15	44	20
SPB 355x2	362	355	5	88	60	313	15	44	20
SPB 400x2	407	400	5	88	60	358	18	44	20
SPB 450x2	457	450	5	90	60	408	18	44	20
SPB 500x2	507	500	5	100	65	458	20	44	25
SPB 560x2	567	560	5	100	65	518	20	44	25
SPB 600x2	607	600	5	100	65	558	20	44	25
SPB 630x2	637	630	5	100	65	588	20	44	25

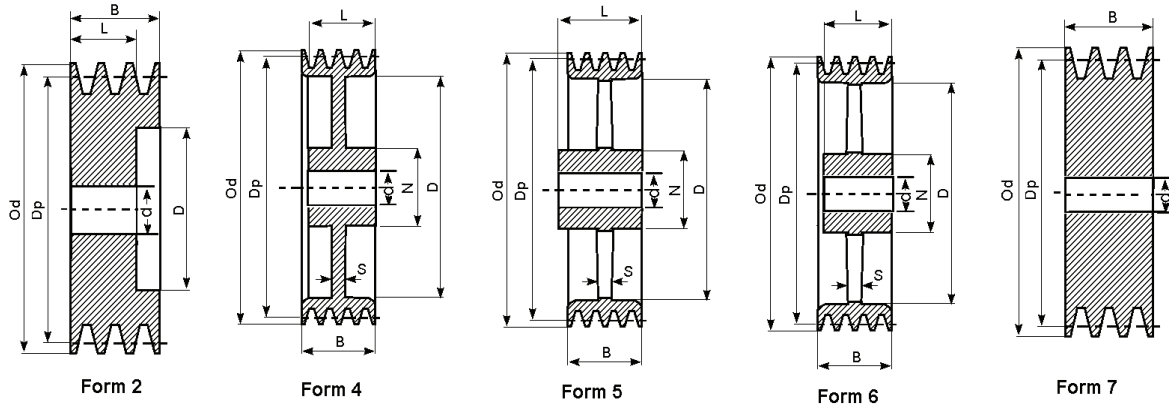

SPB - 3

Description	Od	Dp	Form	N	L	J	E	B	d
SPB 80x3	87	80	7					63	15
SPB 90x3	97	90	7					63	15
SPB 100x3	107	100	7					63	15
SPB 112x3	119	112	7					63	15
SPB 120x3	127	120	7					63	15
SPB 125x3	132	125	2		60	83		63	15
SPB 132x3	139	132	2		60	88		63	15
SPB 140x3	147	140	2		60	98		63	20
SPB 150x3	157	150	2		60	108		63	20
SPB 160x3	167	160	2		60	118		63	20
SPB 170x3	177	170	2	70	60	128		63	20
SPB 180x3	187	180	4	80	60	138	18	63	20
SPB 200x3	207	200	4	80	60	158	18	63	20
SPB 212x3	219	212	4	80	60	170	18	63	20
SPB 225x3	232	225	4	80	60	183	18	63	20
SPB 250x3	257	250	4	88	60	208	18	63	20
SPB 280x3	287	280	4	90	60	238	18	63	20
SPB 300x3	307	300	6	90	60	258	18	63	20
SPB 315x3	322	315	6	90	60	273	18	63	20
SPB 355x3	362	355	6	92	60	313	22	63	25
SPB 400x3	407	400	5	96	65	358	22	63	25
SPB 450x3	457	450	5	96	65	408	24	63	25
SPB 500x3	507	500	5	104	75	458	24	63	25
SPB 560x3	567	560	5	105	75	518	24	63	25
SPB 600x3	607	600	5	104	75	558	24	63	25
SPB 630x3	637	630	5	105	75	588	26	63	25

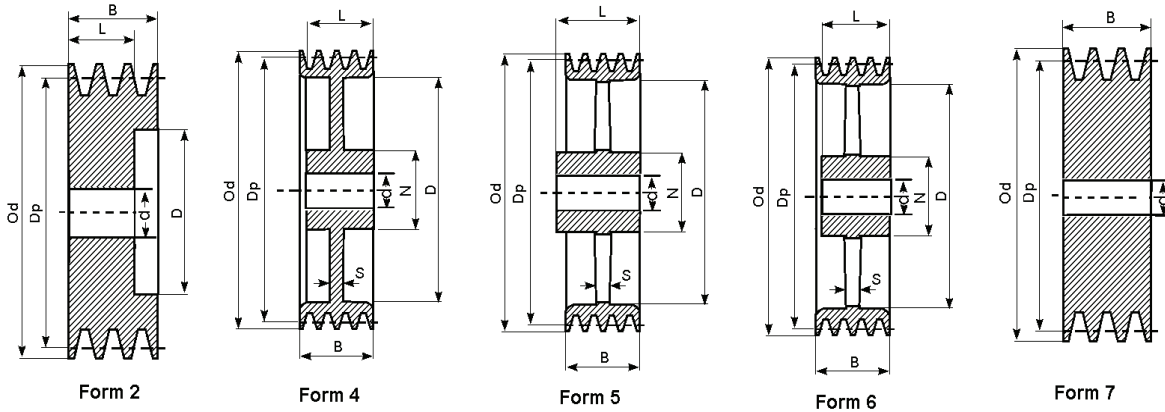

SPB - 4

Description	Od	Dp	Form	N	L	J	E	B	d
SPB 80x4	87	80	7					82	15
SPB 90x4	97	90	7					82	15
SPB 100x4	107	100	7					82	15
SPB 112x4	119	112	7					82	15
SPB 120x4	127	120	7					82	15
SPB 125x4	132	125	2		60	83		82	15
SPB 132x4	139	132	2		60	88		82	15
SPB 140x4	147	140	2		60	98		82	20
SPB 150x4	157	150	2		60	108		82	20
SPB 160x4	167	160	2		60	118		82	20
SPB 170x4	177	170	2		60	128		82	20
SPB 180x4	187	180	2		60	138		82	20
SPB 200x4	207	200	4	88	60	158	25	82	20
SPB 212x4	219	212	4	88	60	170	25	82	20
SPB 225x4	232	225	4	88	60	183	25	82	20
SPB 250x4	257	250	4	96	70	208	25	82	20
SPB 280x4	287	280	4	96	65	238	25	82	20
SPB 300x4	307	300	6	96	65	258	20	82	20
SPB 315x4	322	315	6	96	65	273	20	82	20
SPB 355x4	362	355	6	96	65	313	20	82	25
SPB 400x4	407	400	6	104	75	358	24	82	25
SPB 450x4	457	450	6	104	75	408	24	82	25
SPB 500x4	507	500	5	112	85	458	28	82	25
SPB 560x4	567	560	5	112	85	518	28	82	25
SPB 600x4	607	600	5	115	85	558	28	82	25
SPB 630x4	637	630	5	120	85	588	28	82	25

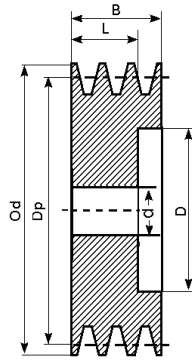

Form 2

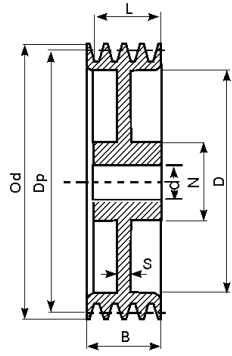

Form 4

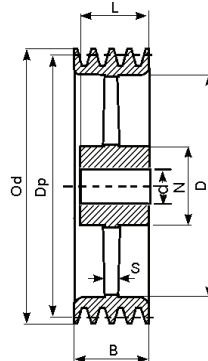

Form 6

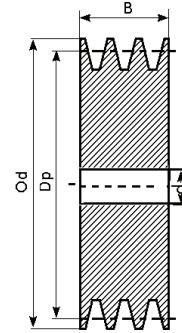

Form 7

SPB - 5

Description	Od	Dp	Form	N	L	J	E	B	d
SPB 80x5	87	80	7					101	15
SPB 90x5	97	90	7					101	15
SPB 100x5	107	100	7					101	15
SPB 112x5	119	112	7					101	15
SPB 120x5	127	120	7					101	20
SPB 125x5	132	125	2		60	83		101	20
SPB 132x5	139	132	2		60	88		101	20
SPB 140x5	147	140	2		60	98		101	20
SPB 150x5	157	150	2		60	108		101	20
SPB 160x5	167	160	2		60	118		101	20
SPB 170x5	177	170	2		60	128		101	20
SPB 180x5	187	180	2		70	138		101	20
SPB 200x5	207	200	4	96	70	158	25	101	25
SPB 212x5	219	212	4	96	70	170	25	101	25
SPB 225x5	232	225	4	96	70	183	25	101	25
SPB 250x5	257	250	4	104	75	208	25	101	25
SPB 280x5	287	280	4	104	75	238	25	101	25
SPB 300x5	307	300	6	104	75	258	22	101	25
SPB 315x5	322	315	6	104	75	273	22	101	25
SPB 355x5	362	355	6	104	75	313	22	101	25
SPB 400x5	407	400	6	112	85	358	24	101	25
SPB 450x5	457	450	6	112	85	408	26	101	25
SPB 500x5	507	500	6	120	90	458	30	101	25
SPB 560x5	567	560	6	120	90	518	30	101	25
SPB 600x5	607	600	6	120	90	558	30	101	25
SPB 630x5	637	630	6	128	90	588	30	101	25

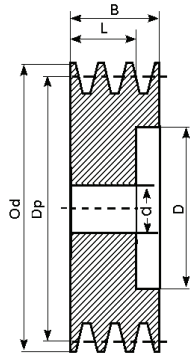

Form 2

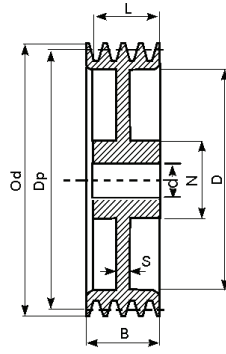

Form 4

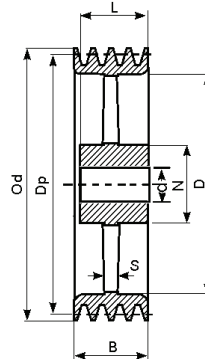

Form 6

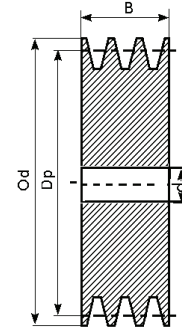

Form 7

SPB - 6

Description	Od	Dp	Form	N	L	J	E	B	d
SPB 120x6	127	120	7					120	20
SPB 125x6	132	125	2		60	83		120	20
SPB 132x6	139	132	2		60	88		120	20
SPB 140x6	147	140	2		60	98		120	20
SPB 150x6	157	150	2		60	108		120	20
SPB 160x6	167	160	2		65	118		120	20
SPB 170x6	177	170	2		65	128		120	20
SPB 180x6	187	180	2		70	138		120	20
SPB 200x6	207	200	4	96	70	158	25	120	25
SPB 212x6	219	212	4	104	80	170	25	120	25
SPB 225x6	232	225	4	104	80	183	25	120	25
SPB 250x6	257	250	4	104	80	208	25	120	25
SPB 280x6	287	280	4	104	80	238	25	120	25
SPB 300x6	307	300	6	104	80	258	25	120	25
SPB 315x6	322	315	6	120	90	273	25	120	25
SPB 355x6	362	355	6	120	90	313	25	120	25
SPB 400x6	407	400	6	120	100	358	28	120	25
SPB 450x6	457	450	6	120	100	408	28	120	25
SPB 500x6	507	500	6	129	105	458	33	120	25
SPB 560x6	567	560	6	129	105	518	33	120	25
SPB 600x6	607	600	6	129	105	558	33	120	25
SPB 630x6	637	630	6	140	105	588	33	120	25

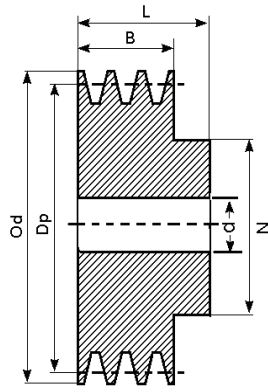

Form 1

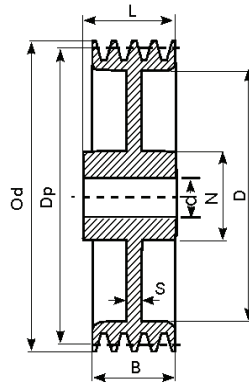

Form 3

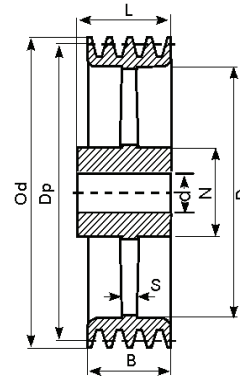

Form 5

SPC - 1

Description	Od	Dp	Form	N	L	J	E	B	d
SPC 100x1	109.6	100	1	60	50			34	15
SPC 120x1	129.6	120	1	65	50			34	15
SPC 140x1	149.6	140	1	70	50			34	20
SPC 150x1	159.6	150	1	70	50			34	20
SPC 160x1	169.6	160	1	72	50			34	20
SPC 180x1	189.6	180	3	76	50	123	16	34	20
SPC 200x1	209.6	200	3	76	50	143	16	34	20
SPC 225x1	234.6	225	3	86	50	168	16	34	20
SPC 250x1	259.6	250	3	86	50	193	16	34	20
SPC 280x1	289.6	280	3	86	50	223	16	34	20
SPC 300x1	309.6	300	3	86	50	243	16	34	20
SPC 315x1	324.6	315	5	92	50	258	16	34	20
SPC 340x1	349.6	340	5	100	50	283	16	34	20
SPC 355x1	364.5	355	5	110	50	298	16	34	20
SPC 400x1	409.6	400	5	110	60	343	18	34	25
SPC 450x1	459.6	450	5	110	60	393	18	34	25
SPC 500x1	509.6	500	5	114	60	443	18	34	25
SPC 560x1	569.6	560	5	114	60	503	20	34	25
SPC 600x1	609.6	600	5	114	60	543	20	34	25
SPC 630x1	639.6	630	5	114	60	573	20	34	25

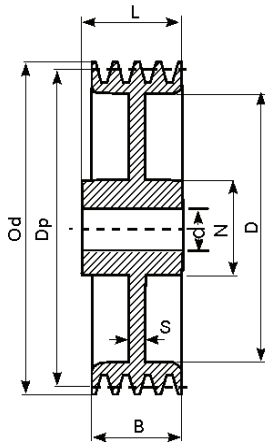

Form 3

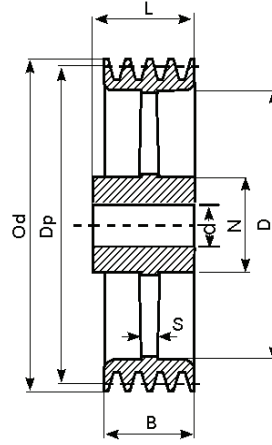

Form 5

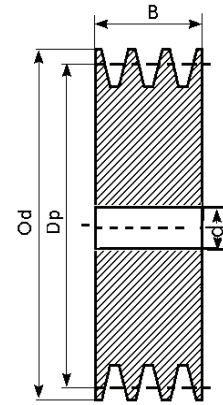

Form 7

SPC - 2

Description	Od	Dp	Form	N	L	J	E	B	d
SPC 120x2	129.6	120	7					59.5	15
SPC 140x2	149.6	140	7					59.5	20
SPC 150x2	159.6	150	7					59.5	20
SPC 160x2	169.6	160	7					59.5	20
SPC 180x2	180.6	180	3	80	60	123	16	59.5	20
SPC 200x2	209.6	200	3	80	60	143	16	59.5	20
SPC 225x2	234.6	225	3	88	60	168	18	59.5	20
SPC 250x2	259.6	250	3	92	60	193	18	59.5	20
SPC 280x2	289.6	280	3	92	60	223	18	59.5	20
SPC 300x2	309.6	300	3	92	60	243	18	59.5	20
SPC 315x2	324.6	315	5	92	60	258	18	59.5	20
SPC 340x2	349.6	340	5	100	60	283	18	59.5	20
SPC 355x2	364.6	355	5	110	60	298	18	59.5	25
SPC 400x2	409.6	400	5	110	70	343	20	59.5	25
SPC 450x2	459.6	450	5	110	70	393	20	59.5	25
SPC 500x2	509.6	500	5	114	70	443	20	59.5	25
SPC 560x2	569.6	560	5	114	70	503	24	59.5	25
SPC 600x2	609.6	600	5	114	70	543	24	59.5	20
SPC 630x2	639.6	630	5	114	70	573	24	59.5	20

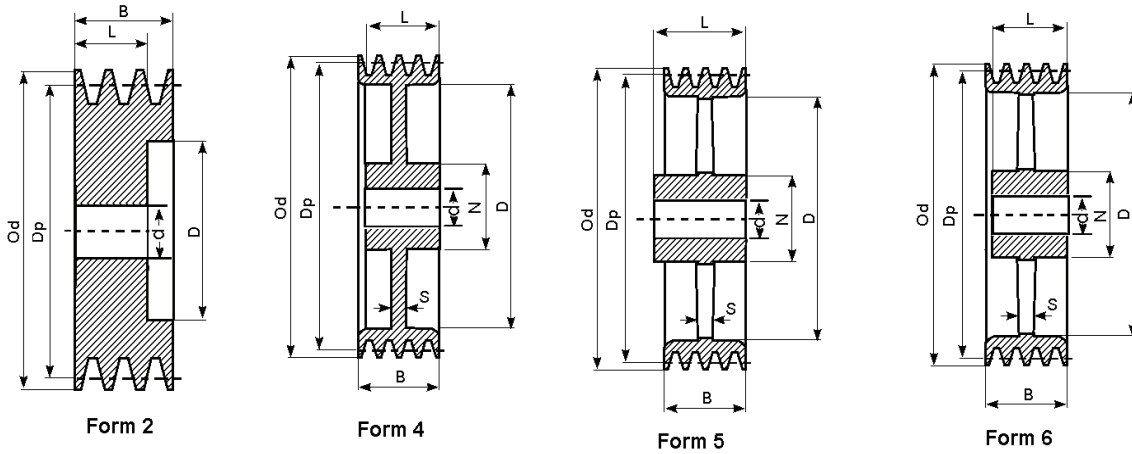

SPC - 3

Description	Od	Dp	Form	N	L	J	E	B	d
SPC 140x3	149.6	140	2		65	83		85	20
SPC 150x3	159.6	150	2		65	93		85	20
SPC 160x3	169.6	160	2		65	103		85	20
SPC 180x3	189.6	180	4	82	65	123	18	85	20
SPC 200x3	209.6	200	4	86	65	143	18	85	20
SPC 225x3	234.6	225	4	90	70	168	21	85	20
SPC 250x3	259.6	250	4	92	70	193	21	85	20
SPC 280x3	289.6	280	4	92	70	223	21	85	20
SPC 300x3	309.6	300	4	90	70	243	21	85	20
SPC 315x3	324.6	315	6	92	70	258	22	85	25
SPC 340x3	349.6	340	6	100	70	283	22	85	25
SPC 355x3	364.6	355	6	110	70	298	22	85	25
SPC 400x3	409.6	400	5	114	90	343	24	85	25
SPC 450x3	459.6	450	5	114	90	393	24	85	25
SPC 500x3	509.6	500	5	114	90	443	24	85	25
SPC 560x3	569.6	560	5	114	90	503	28	85	25
SPC 600x3	609.6	600	5	114	90	543	28	85	25
SPC 630x3	639.6	630	5	114	90	573	28	85	25

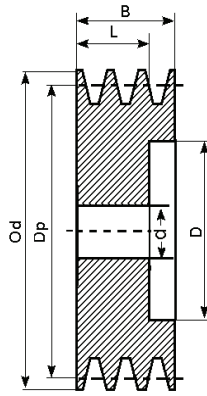

Form 2

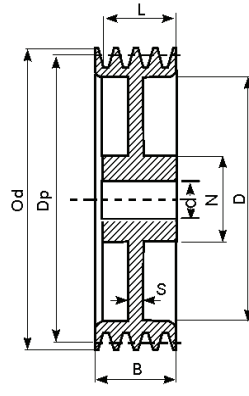

Form 4

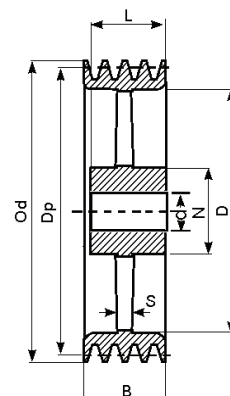

Form 6

SPC - 4

Description	Od	Dp	Form	N	L	J	E	B	d
SPC 140x4	149.6	140	2		80	83		110.5	20
SPC 150x4	159.6	150	2		80	93		110.5	20
SPC 160x4	169.6	160	2		80	103		110.5	20
SPC 180x4	189.6	180	4	82	80	123	20	110.5	20
SPC 200x4	209.6	200	4	90	90	143	25	110.5	20
SPC 225x4	234.6	225	4	90	90	168	25	110.5	25
SPC 250x4	259.6	250	4	100	90	193	25	110.5	25
SPC 280x4	289.6	280	4	100	70	223	25	110.5	25
SPC 300x4	309.6	300	4	100	90	243	25	110.5	25
SPC 315x4	324.6	315	6	110	90	258	25	110.5	25
SPC 340x4	349.6	340	6	114	90	283	25	110.5	25
SPC 355x4	364.6	355	6	114	90	298	25	110.5	25
SPC 400x4	409.6	400	6	120	90	343	26	110.5	25
SPC 450x4	459.6	450	6	120	90	393	28	110.5	25
SPC 500x4	509.6	500	6	126	100	443	28	110.5	25
SPC 560x4	569.6	560	6	130	100	503	30	110.5	25
SPC 600x4	609.6	600	6	130	100	543	30	110.5	25
SPC 630x4	639.6	630	6	130	100	573	30	110.5	25

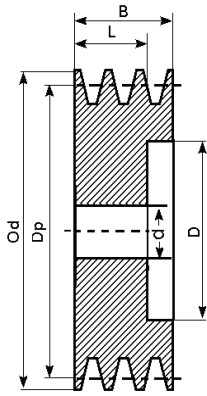

Form 2

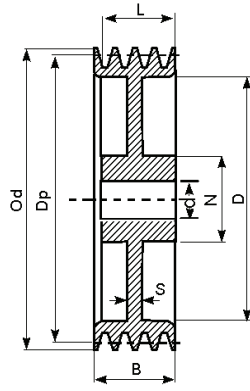

Form 4

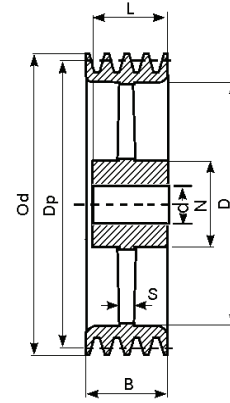

Form 6

SPC - 5

Description	Od	Dp	Form	N	L	J	E	B	d
SPC 150x5	159.6	150	2		96	93		136	20
SPC 160x5	169.6	160	2		96	103		136	20
SPC 180x5	189.6	180	4	82	96	123	20	136	20
SPC 200x5	209.6	200	4	90	100	143	25	136	25
SPC 225x5	234.6	225	4	90	100	168	25	136	25
SPC 250x5	259.6	250	4	102	100	193	25	136	25
SPC 280x5	289.6	280	4	102	100	223	25	136	25
SPC 300x5	309.6	300	4	104	100	243	25	136	25
SPC 315x5	324.6	315	6	112	100	258	25	136	25
SPC 340x5	349.6	340	6	114	100	283	28	136	25
SPC 355x5	364.6	355	6	114	100	298	28	136	25
SPC 400x5	409.6	400	6	120	100	343	28	136	25
SPC 450x5	459.6	450	6	120	100	393	30	136	25
SPC 500x5	509.6	500	6	126	100	443	30	136	25
SPC 560x5	569.6	560	6	130	100	503	32	136	25
SPC 600x5	609.6	600	6	130	100	543	32	136	25
SPC 630x5	639.6	630	6	130	100	573	32	136	25

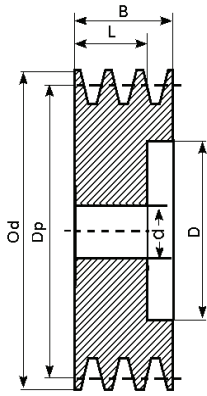

Form 2

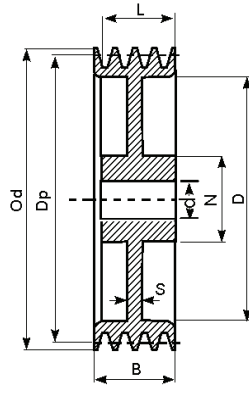

Form 4

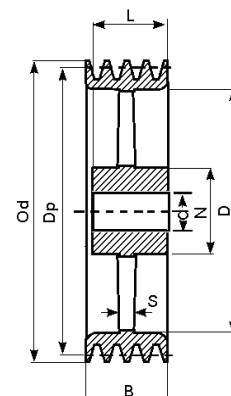

Form 6

SPC - 6

Description	Od	Dp	Form	N	L	J	E	B	d
SPC 160x6	169.6	160	2		96	103		161.5	20
SPC 180x6	189.6	180	4	82	96	123	25	161.5	20
SPC 200x6	209.6	200	4	90	100	143	25	161.5	25
SPC 225x6	234.6	225	4	90	100	168	25	161.5	25
SPC 250x6	259.6	250	4	102	100	193	25	161.5	25
SPC 280x6	289.6	280	4	102	100	223	25	161.5	25
SPC 300x6	309.6	300	4	104	100	243	25	161.5	25
SPC 315x6	324.6	315	4	112	100	258	28	161.5	25
SPC 340x6	349.6	340	6	114	100	283	30	161.5	25
SPC 355x6	364.6	355	6	114	100	298	30	161.5	25
SPC 400x6	409.6	400	6	120	100	343	30	161.5	25
SPC 450x6	459.6	450	6	120	100	393	32	161.5	25
SPC 500x6	509.6	500	6	126	100	443	32	161.5	25
SPC 560x6	569.6	560	6	130	100	503	35	161.5	25
SPC 600x6	609.6	600	6	130	100	543	35	161.5	25
SPC 630x6	639.6	630	6	130	100	573	35	161.5	25

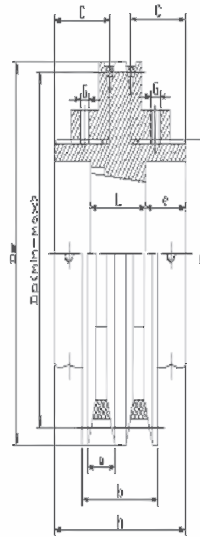
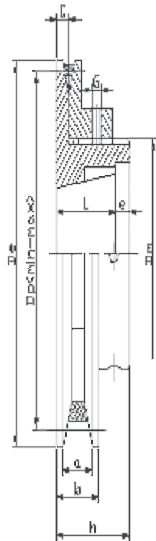

SPZ - SPA - SPB

SIZE	Bore of bush	De	Dm	Dp Min/Max	a Max/Min	b max	b min	c	e	G	h	L
84xZ1 1108	10-28mm	84	50	62 / 80	14.5 / 10	19.5	15	7.5		6	28	28.8
95xZ1 1108	10-28mm	95	60	73 / 91	14.5 / 10	20.5	16	8.0	8.0	6	30	22.0
100xZ1 1108	10-28mm	100	60	78 / 96	14.5 / 10	20.5	16	8.0	8.0	6	30	22.0
108xZ1 1210	11-30mm	108	72	90 / 104	13.2 / 10	19.2	16	8.0	10.0	8	35	25.0
108xA1 1210	11-30mm	108	62	76 / 102	19.5 / 13	25.5	19	9.5	12.0	8	39	27.0
120xA1 1210	11-30mm	120	72	88 / 114	19.5 / 13	26.5	20	10.0	10.0	8	36	26.0
120xA2 1215	11-30mm	120	72	88 / 114	19.5 / 13	47.1	34	26.0	12.0	8	66	40.5
129xA1 1210	11-30mm	129	72	97 / 123	19.5 / 13	26.5	20	10.0	10.0	8	36	26.0
129xA2 1215	11-30mm	129	72	97 / 123	19.5 / 13	47.1	34	26.0	12.0	8	66	40.5
139xA1 1610	14-40mm	139	85	109 / 133	18.9 / 13	25.9	20	10.0	11.0	8	37	26.0
139xA2 1615	14-40mm	139	85	109 / 133	18.9 / 13	46.8	35	27.0	14.5	8	69	38.5
146xA1 1610	14-40mm	146	85	116 / 140	18.9 / 13	25.9	20	10.0	11.0	8	37	26.0
146xA2 1615	14-40mm	146	85	116 / 140	18.9 / 13	46.8	35	27.0	14.5	8	69	38.5
156xA1 1610	14-40mm	156	85	126 / 150	18.9 / 13	25.9	20	10.0	11.0	8	37	26.0
156xA2 1615	14-40mm	156	85	126 / 150	18.9 / 13	46.8	35	27.0	14.5	8	69	38.5
164xA1 1610	14-40mm	164	85	134 / 158	18.9 / 13	25.9	20	10.0	8.0	8	37	29.0
164xA2 1615	14-40mm	164	85	134 / 158	18.9 / 13	46.8	35	27.0	15.5	8	69	37.5
177xA1 2012	18-50mm	177	110	149 / 171	18.2 / 13	25.2	20	10.0	8.0	8	40	32.0
177xA2 2012	18-50mm	177	110	149 / 171	18.2 / 13	45.5	35	37.5	24.0	8	90	37.0
187xA1 2012	18-50mm	187	110	159 / 181	18.2 / 13	25.2	20	10.0	8.0	8	40	32.0
187xA2 2012	18-50mm	187	110	159 / 181	18.2 / 13	45.5	35	37.5	24.0	8	90	37.0
178xB1 2012	18-50mm	178	110	139 / 171	25.1 / 17	28.1	20	10.0	8.0	8	40	32.0
178xB2 2012	18-50mm	178	110	139 / 171	25.1 / 17	45.5	35	37.5	24.0	8	90	37.0
187xB1 2012	18-50mm	187	110	148 / 180	25.1 / 17	28.1	20	10.0	8.0	8	40	32.0
187xB2 2012	18-50mm	187	110	148 / 180	25.1 / 17	45.5	35	37.5	24.0	8	90	37.0
200xB1 2012	18-50mm	200	110	161 / 193	25.1 / 17	32.0	24	12.0	12.5	8	45	32.0
200xB2 2012	18-50mm	200	110	161 / 193	25.1 / 17	64.0	44	35.0	29.0	8	90	32.0
232xB1 2012	18-50mm	232	110	193 / 225	25.1 / 17	32.0	24	12.0	12.5	8	45	32.0
232xB2 2012	18-50mm	232	110	193 / 225	25.1 / 17	64.0	44	35.0	29.0	8	90	32.0
250xB1 2517	20-60mm	250	130	211 / 243	25.1 / 17	32.0	24	12.0	0.0	8	45	45.0
250xB2 2517	20-60mm	250	130	211 / 243	25.1 / 17	64.0	44	35.0	22.5	8	90	45.0